

LEGEND  
 ROUTE FROM NEWTOWN TO SSA C

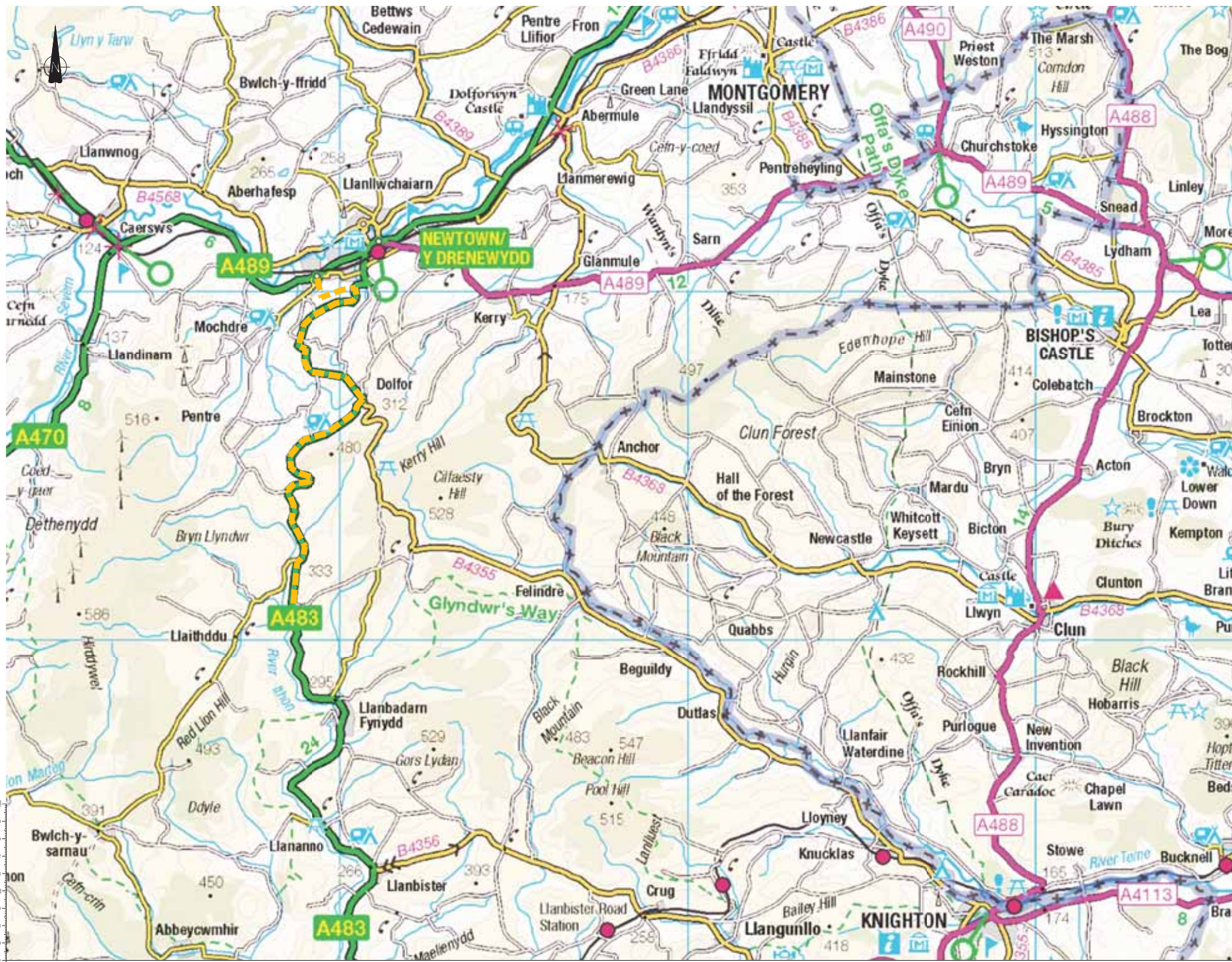

REV	DESCRIPTION	CD	SDC	AM	DATE
A	WORKSHOP COMMENTS				10/11/13
-	FIRST ISSUE				08/11/13
	AMENDMENTS	BY	CHKD	APRD	DATE



CLIENT  
 RENEWABLEUK CYMRU

PROJECT  
 STRATEGIC TRAFFIC MANAGEMENT PLAN FOR MID WALES WIND FARMS

TITLE  
 FIGURE 6-1  
 ROUTE FROM NEWTOWN TO SSA C

STATUS  
 FOR INFORMATION

DRAWN	CHECKED	APPROVED
RT	CD	SDC
DATE 05/11/13	DATE 05/11/13	DATE 08/11/13
DRAWING SCALE 1:50,000 @A1/1:100,000 @A3	ORIGINAL DRAWING SIZE 594 x 841 - A1	
DRAWING NO.	REV.	
108526-FIG 6-1	A	



LEGEND  
 ROUTE FROM NEWTOWN TO SSA C

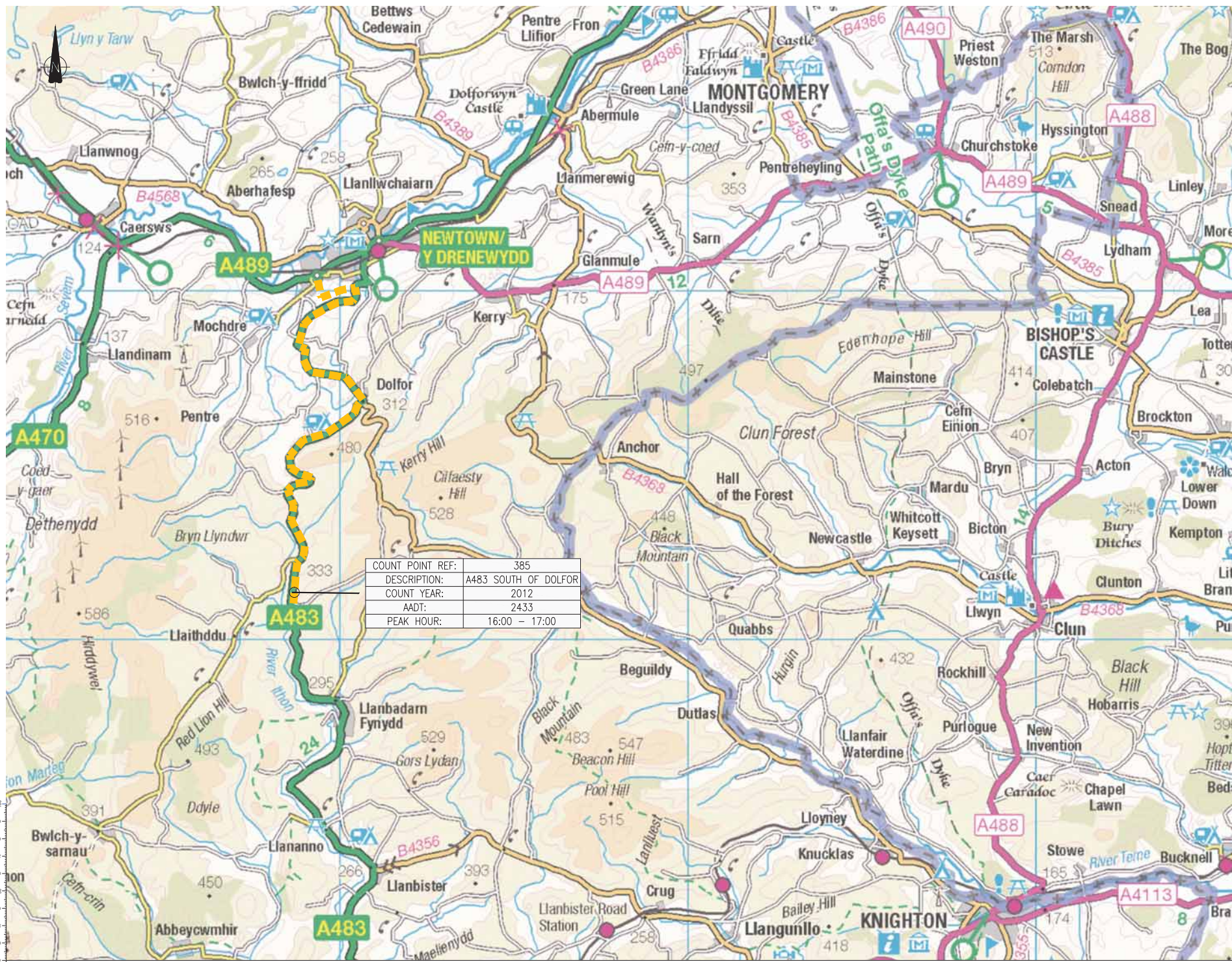

NO.	DESCRIPTION	CD	SDC	AM	DATE
1	WORKSHOP COMMENTS				05/11/13
2	FIRST ISSUE				05/11/13
3	AMENDMENTS				



CLIENT  
 RENEWABLEUK CYMRU

PROJECT  
 STRATEGIC TRAFFIC MANAGEMENT PLAN FOR MID WALES WIND FARMS

TITLE  
 FIGURE 6-2 TRAFFIC FLOWS ALONG ROUTE FROM NEWTOWN TO SSA C

STATUS  
 FOR INFORMATION

DRAWN	CHECKED	APPROVED
RT	CD	SDC
DATE: 05/11/13	DATE: 05/11/13	DATE: 08/11/13
DRAWING SCALE: 1:50,000 @A1/1:100,000 @A3	ORIGINAL DRAWING SIZE: 594 x 841 - A1	
DRAWING NO.	REV.	

108526-FIG 6-2 A



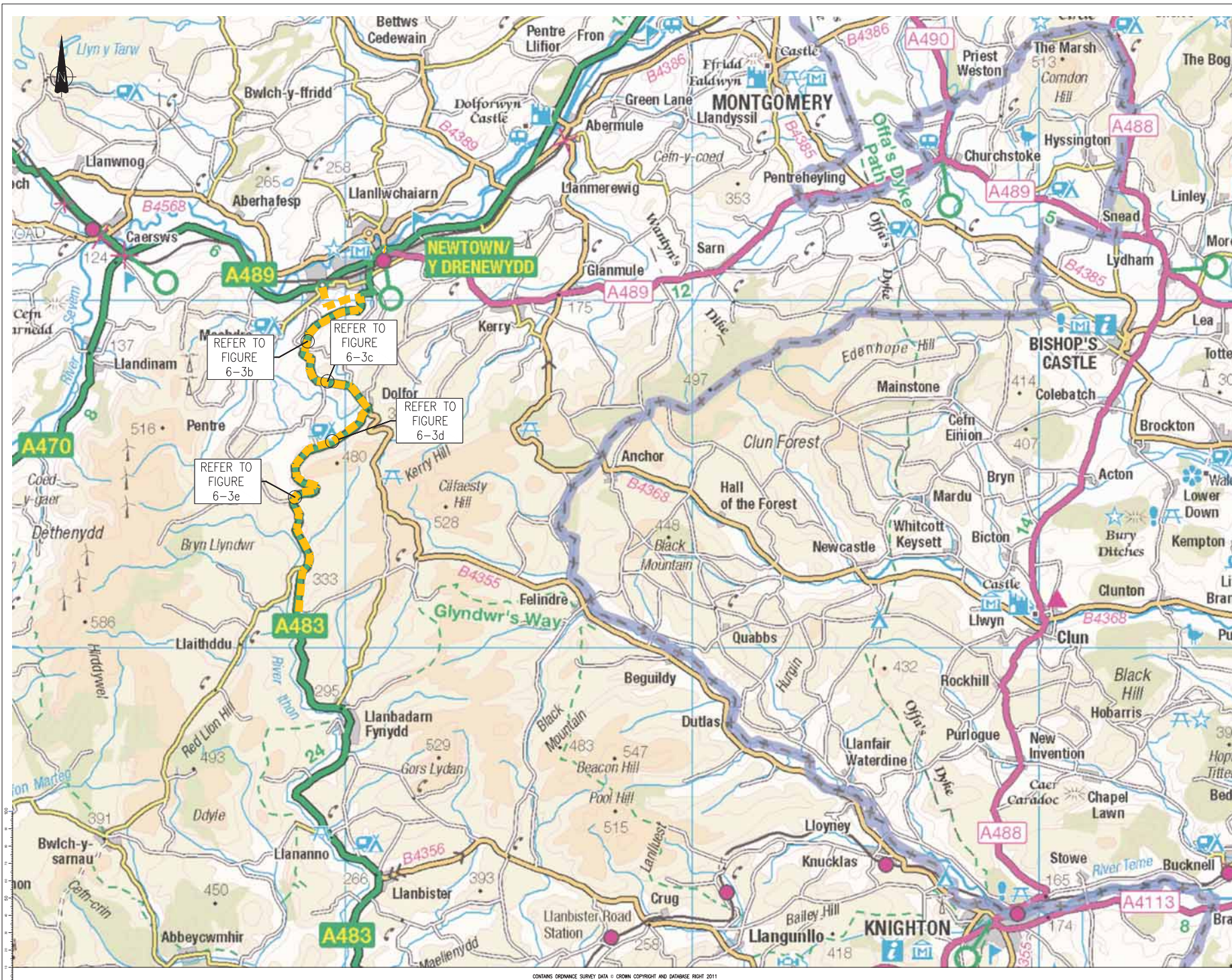

NOTES

LEGEND

ROUTE FROM NEWTOWN TO SSA C

REFER TO FIGURE 6-3b

REFER TO FIGURE 6-3c

REFER TO FIGURE 6-3d

REFER TO FIGURE 6-3e

REV	WORKSHOP COMMENTS	CD	SDC	KM	15/11/13
-	FIRST ISSUE	CD	SDC	KM	15/11/13
	AMENDMENTS	BY	CHKD	APVD	DATE



CLIENT

RENEWABLEUK CYMRU

PROJECT

STRATEGIC TRAFFIC MANAGEMENT PLAN FOR MID WALES WIND FARMS

TITLE

FIGURE 6-3a  
PASSING PLACES ALONG ROUTE FROM NEWTOWN TO SSA C

STATUS

FOR INFORMATION

DRAWN	CHECKED	APPROVED
RT	CD	SDC
DATE 08/11/13	DATE 08/11/13	DATE 08/11/13
DRAWING SCALE 1:50,000 @A1/1:100,000 @A3	ORIGINAL DRAWING SIZE 594 x 841 - A1	
DRAWING NO	REV	

108526-FIG 6-3a A





EXISTING FILTER DRAIN WITHIN THE VERGE TO BE RETAINED BENEATH REINFORCED GRASS CONSTRUCTION

VISIBILITY IMPACTED FOR THROUGH TRAFFIC. POLICE ESCORT NEEDED AT ALL TIMES

INSUFFICIENT VERGE WIDTH TO PERMIT THE CONVOY TO BE HELD ENTIRELY OFF CARRIAGEWAY, LEAVING APPROXIMATELY 4.3m AVAILABLE TO ALLOW ONE WAY TRAFFIC TO PASS THE CONVOY. SEE FIGURE 1-3a FOR TYPICAL DETAILS.

NO IMPACT ON CUT SLOPE

NO IMPACT ON TELEGRAPH POLES

NO IMPACT ON TELEGRAPH POLES

RELOCATED STAGGERED JUNCTION WARNING SIGN. EXACT LOCATION TO BE CONFIRMED DURING DETAILED DESIGN. REQUISITE VISIBILITY APPEARS TO BE ACHIEVABLE.

TREE TO BE REMOVED

TEMPORARY BLOCKING OF FIELD ACCESSES BY CONVOY WHEN STOPPED AT PASSING PLACE

PASSING PLACE 6-3b  
PARTIALLY OFF CARRIAGEWAY PASSING PLACE ONE WAY RAFFIC PAST THE CONVOY  
SCALE 1:500 AT A1  
SCALE 1:1000 AT A3

DISTANCE TO NEXT PASSING PLACE APPROXIMATELY 1.3km

Severn View

DISTANCE TO MOCHDRE LINK APPROXIMATELY 2.1km

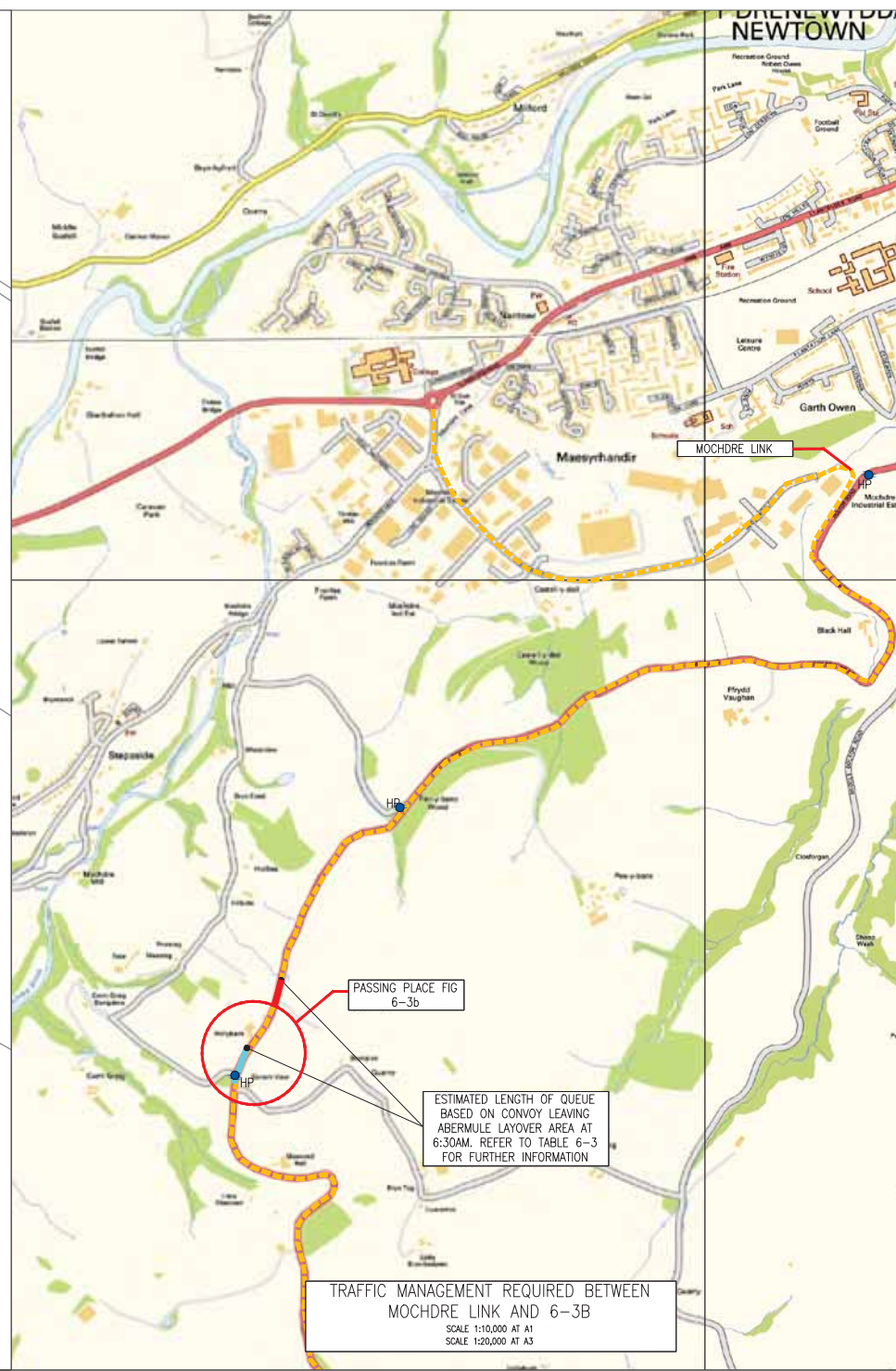

PASSING PLACE FIG 6-3b

ESTIMATED LENGTH OF QUEUE BASED ON CONVOY LEAVING ABERMULE LAYOVER AREA AT 6:30AM. REFER TO TABLE 6-3 FOR FURTHER INFORMATION

TRAFFIC MANAGEMENT REQUIRED BETWEEN MOCHDRE LINK AND 6-3B  
SCALE 1:10,000 AT A1  
SCALE 1:20,000 AT A3

NOTES

- LEGEND**
- ROUTE FROM NEWTOWN TO SSA C
  - HP POLICE HOLDING POINT
  - RS ROAD SIGN
  - TP TELEGRAPH POLE
  - HARDENED VERGE
  - RETAINING STRUCTURE
  - SAFETY BARRIER
  - ESTIMATED FOLLOWING TRAFFIC QUEUE
  - ESTIMATED OPPOSING TRAFFIC QUEUE
  - PHOTOGRAPH LOCATION AND DIRECTION
  - NEW CARRIAGEWAY SURFACE

- VEHICLES LEGEND**
- TOWER BASE SECTION VEHICLE
  - 45m BLADE VEHICLE
  - CIVILIAN ESCORT VEHICLE
  - POLICE ESCORT VEHICLE
  - BOLLARD REMOVAL/ REPLACEMENT VEHICLE

- NOTES**
1. REFER TO FIGURE 1-4a FOR FURTHER INFORMATION ON ASSUMED DELIVERY VEHICLES.
  2. BLADE DELIVERY VEHICLE ASSUMED TO LEAD AS IT WILL SET THE CONVOY SPEED.
  3. ENVIRONMENTAL ASSESSMENT OF PROPOSED WORKS TO BE UNDERTAKEN BY OTHERS.
  4. THE WORKS IDENTIFIED ARE PRELIMINARY SOLUTIONS ONLY. TOPOGRAPHICAL SURVEY OF THE AREA MAY BE REQUIRED PRIOR TO FURTHER DESIGN DEVELOPMENT.
  5. ONSITE MEASUREMENTS TAKEN AT LOCATIONS OF PROPOSED PASSING PLACES.

G	WELSH GOVERNMENT (TRANSPORT DIVISION) COMMENTS	LA	SC	KM	18/12/13
F	WELSH GOVERNMENT (TRANSPORT DIVISION) COMMENTS	JC	SC	KM	17/12/13
E	WELSH GOVERNMENT (TRANSPORT DIVISION) COMMENTS	LA	SC	KM	13/12/13
D	WELSH GOVERNMENT (TRANSPORT DIVISION) COMMENTS	JC	SC	KM	12/12/13
C	CLIENT REVIEW	JC	SC	KM	28/12/13
B	CLIENT REVIEW	DM	SC	KM	20/11/13
A	WORKSHOP COMMENTS	DM	SC	KM	15/11/13
-	INITIAL ISSUE	DM	SC	KM	06/11/13
REV	AMENDMENTS	BY	CHGD	APPRD	DATE



CLIENT  
**RENEWABLEUK CYMRU**

PROJECT  
**STRATEGIC TRAFFIC MANAGEMENT PLAN FOR MID WALES WIND FARMS**

TITLE  
**FIGURE 6-3b PASSING PLACE HOLLYBANK**

STATUS  
**FOR INFORMATION**

DRAWN RT	CHECKED CD	APPROVED SDC
DATE 18.11.13	DATE 08.11.13	DATE 08.11.13
DRAWING SCALE AS SHOWN		ORIGINAL DRAWING SIZE 594 x 841 - A1
DRAWING NO. 108526-FIG 6-3b		REV. G

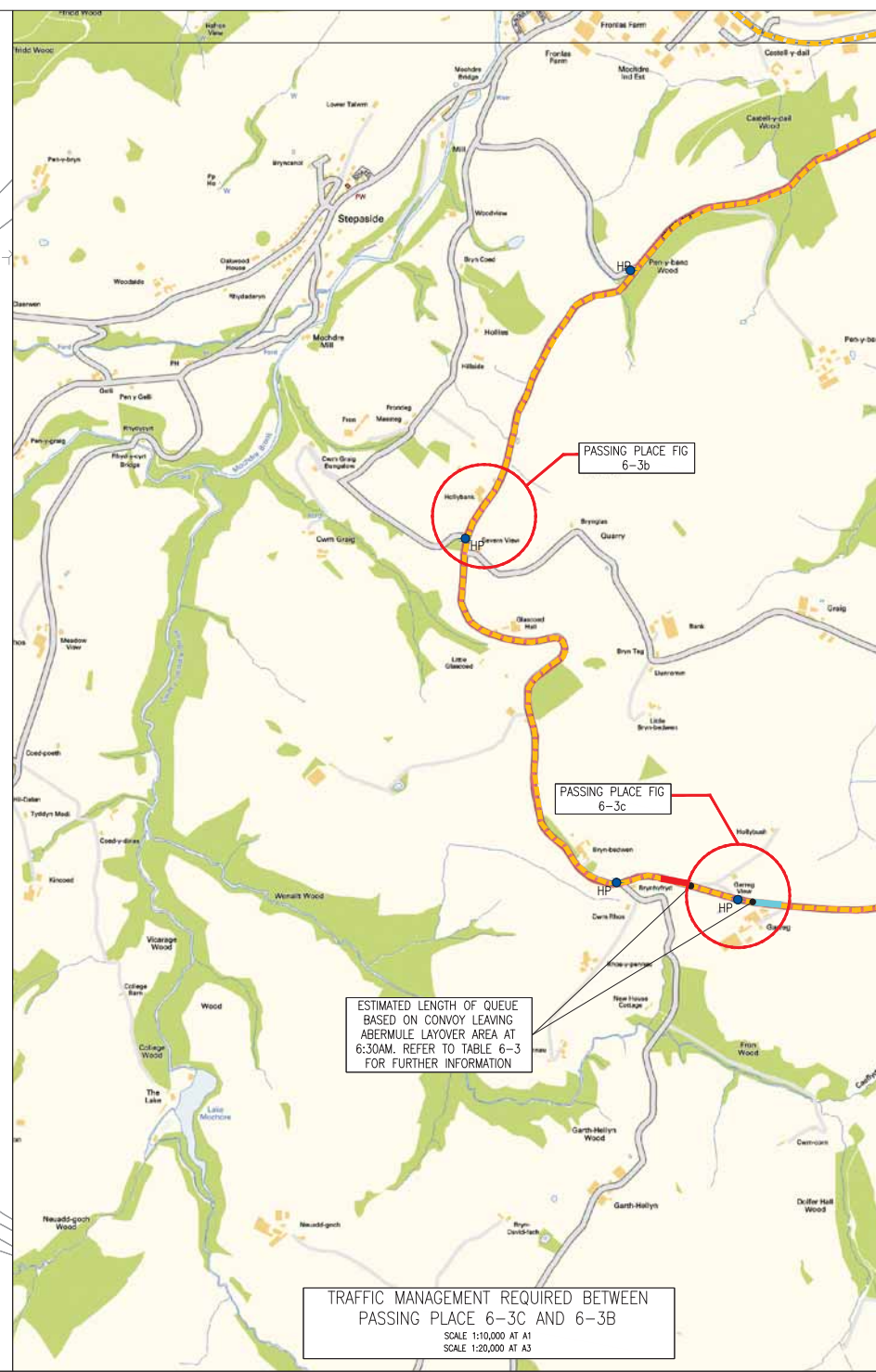
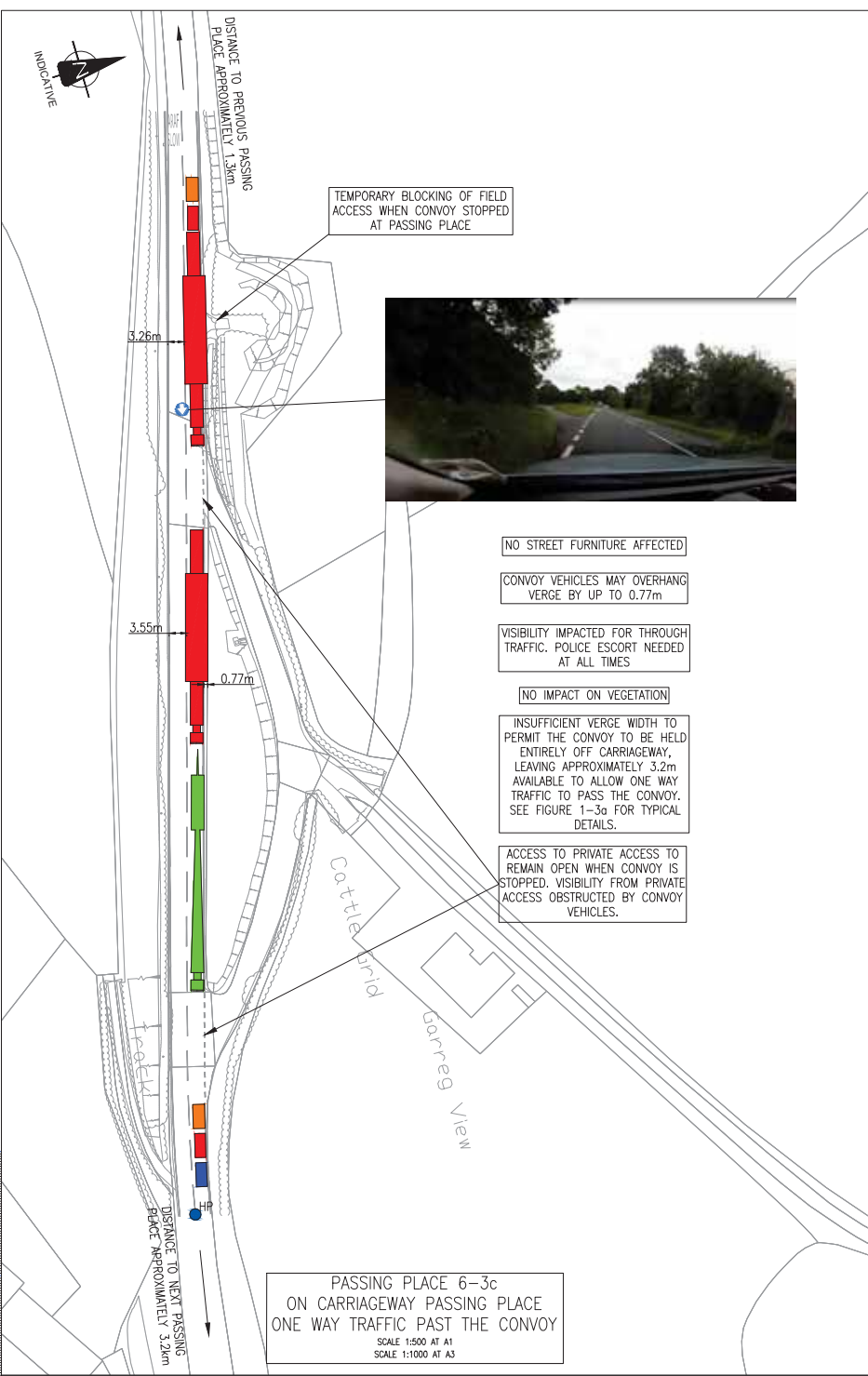

REV	AMENDMENTS	BY	CHKD	APRD	DATE
G	WELSH GOVERNMENT (TRANSPORT DIVISION) COMMENTS	LA	SC	KM	18/12/13
F	WELSH GOVERNMENT (TRANSPORT DIVISION) COMMENTS	JC	SC	KM	17/12/13
E	WELSH GOVERNMENT (TRANSPORT DIVISION) COMMENTS	LA	SC	KM	13/12/13
D	WELSH GOVERNMENT (TRANSPORT DIVISION) COMMENTS	JC	SC	KM	12/12/13
C	CLIENT REVIEW	JC	SC	KM	28/11/13
B	CLIENT REVIEW	DM	SC	KM	20/11/13
A	WORKSHOP COMMENTS	DM	SC	KM	15/11/13
-	FIRST ISSUE	DM	SC	KM	08/11/13



CLIENT	RENEWABLEUK CYMRU					
PROJECT	STRATEGIC TRAFFIC MANAGEMENT PLAN FOR MID WALES WIND FARMS					
TITLE	FIGURE 6-3c PASSING PLACE GARREG VIEW					
STATUS	FOR INFORMATION					
DRAWN	RT	CHECKED	CD	APPROVED	SDC	
DATE	08.11.13	DATE	08.11.13	DATE	08.11.13	
DRAWING SCALE	AS SHOWN	ORIGINAL DRAWING SIZE	594 x 841 - A1			
DRAWING NO.	108526-FIG 6-3c				REV	G



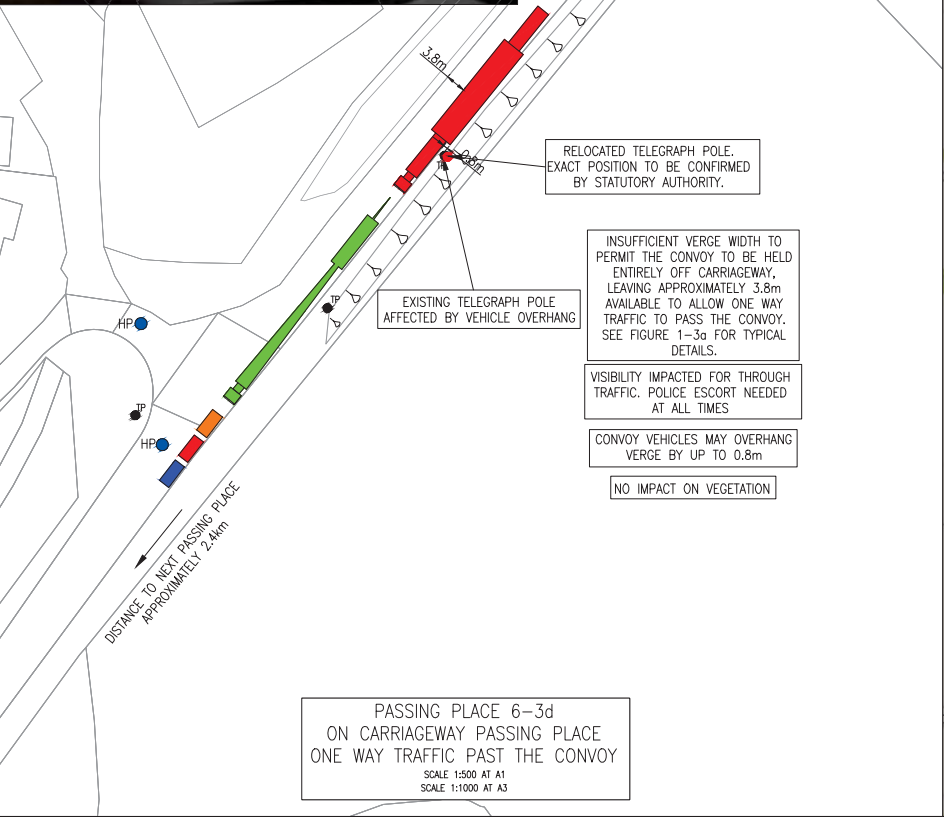

PASSING PLACE 6-3d  
ON CARRIWAY PASSING PLACE  
ONE WAY TRAFFIC PAST THE CONVOY  
SCALE 1:500 AT A1  
SCALE 1:1000 AT A3

INSUFFICIENT VERGE WIDTH TO PERMIT THE CONVOY TO BE HELD ENTIRELY OFF CARRIWAY, LEAVING APPROXIMATELY 3.8m AVAILABLE TO ALLOW ONE WAY TRAFFIC TO PASS THE CONVOY. SEE FIGURE 1-3c FOR TYPICAL DETAILS.

VISIBILITY IMPACTED FOR THROUGH TRAFFIC. POLICE ESCORT NEEDED AT ALL TIMES

CONVOY VEHICLES MAY OVERHANG VERGE BY UP TO 0.8m

NO IMPACT ON VEGETATION

RELOCATED TELEGRAPH POLE. EXACT POSITION TO BE CONFIRMED BY STATUTORY AUTHORITY.

EXISTING TELEGRAPH POLE AFFECTED BY VEHICLE OVERHANG

DISTANCE FROM PREVIOUS PASSING PLACE APPROXIMATELY 3.2km

DISTANCE TO NEXT PASSING PLACE APPROXIMATELY 2.8km

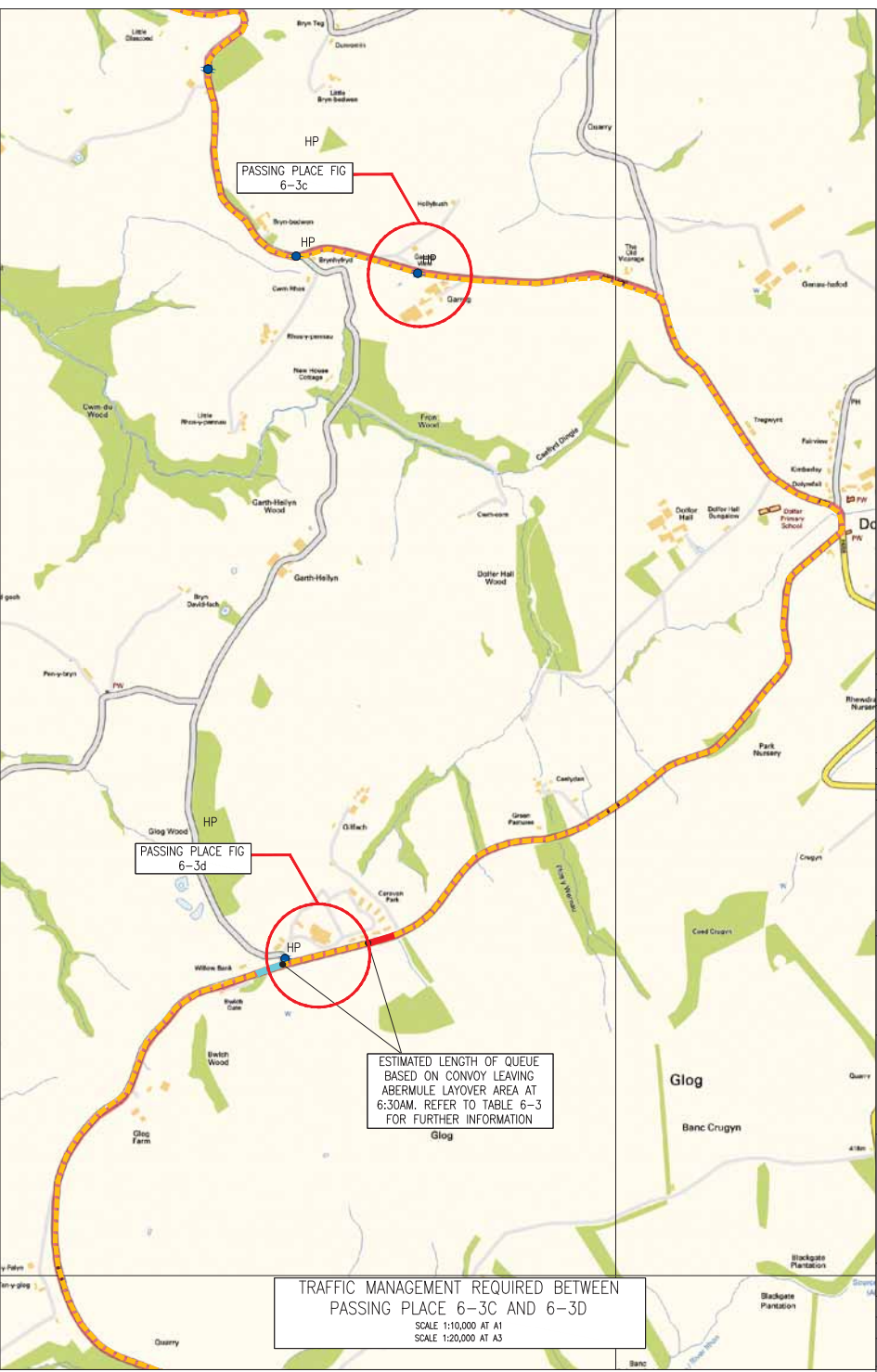

TRAFFIC MANAGEMENT REQUIRED BETWEEN  
PASSING PLACE 6-3C AND 6-3D  
SCALE 1:10,000 AT A1  
SCALE 1:20,000 AT A3

- LEGEND**
- ROUTE FROM NEWTOWN TO SSA C
  - HP POLICE HOLDING POINT
  - RS ROAD SIGN
  - TP TELEGRAPH POLE
  - ▨ HARDENED VERGE
  - RETAINING STRUCTURE
  - SAFETY BARRIER
  - ESTIMATED FOLLOWING TRAFFIC QUEUE
  - ESTIMATED OPPOSING TRAFFIC QUEUE
  - ⊕ PHOTOGRAPH LOCATION AND DIRECTION
  - NEW CARRIWAY SURFACE

- VEHICLES LEGEND**
- TOWER BASE SECTION VEHICLE
  - 45m BLADE VEHICLE
  - CIVILIAN ESCORT VEHICLE
  - POLICE ESCORT VEHICLE
  - BOLLARD REMOVAL/ REPLACEMENT VEHICLE

- NOTES**
1. REFER TO FIGURE 1-4a FOR FURTHER INFORMATION ON ASSUMED DELIVERY VEHICLES.
  2. BLADE DELIVERY VEHICLE ASSUMED TO LEAD AS IT WILL SET THE CONVOY SPEED.
  3. ENVIRONMENTAL ASSESSMENT OF PROPOSED WORKS TO BE UNDERTAKEN BY OTHERS.
  4. THE WORKS IDENTIFIED ARE PRELIMINARY SOLUTIONS ONLY. TOPOGRAPHICAL SURVEY OF THE AREA MAY BE REQUIRED PRIOR TO FURTHER DESIGN DEVELOPMENT.
  5. ONSITE MEASUREMENTS TAKEN AT LOCATIONS OF PROPOSED PASSING PLACES.

REV	AMENDMENTS	BY	CHKD	APRD	DATE
G	WELSH GOVERNMENT (TRANSPORT DIVISION) COMMENTS	LA	SC	KM	18/12/13
F	WELSH GOVERNMENT (TRANSPORT DIVISION) COMMENTS	JC	SC	KM	17/12/13
E	WELSH GOVERNMENT (TRANSPORT DIVISION) COMMENTS	LA	SC	KM	13/12/13
D	CLIENT REVIEW	LA	SC	KM	12/12/13
C	CLIENT REVIEW	JC	SC	KM	05/12/13
B	CLIENT REVIEW	DM	SC	KM	20/11/13
A	WORKSHOP COMMENTS	DM	SC	KM	15/11/13
-	FIRST ISSUE	DM	SC	KM	08/11/13



CLIENT  
**RENEWABLEUK CYMRU**

PROJECT  
**STRATEGIC TRAFFIC MANAGEMENT PLAN FOR MID WALES WIND FARMS**

TITLE  
**FIGURE 6-3d PASSING PLACE WILLOW BANK**

STATUS  
**FOR INFORMATION**

DRAWN	CHECKED	APPROVED
RT	CD	SDC
DATE	DATE	DATE
08.11.13	08.11.13	08.11.13
DRAWING SCALE	ORIGINAL DRAWING SIZE	
AS SHOWN	594 x 841 - A1	
DRAWING NO	REV	DATE
108526-FIG 6-3d	G	

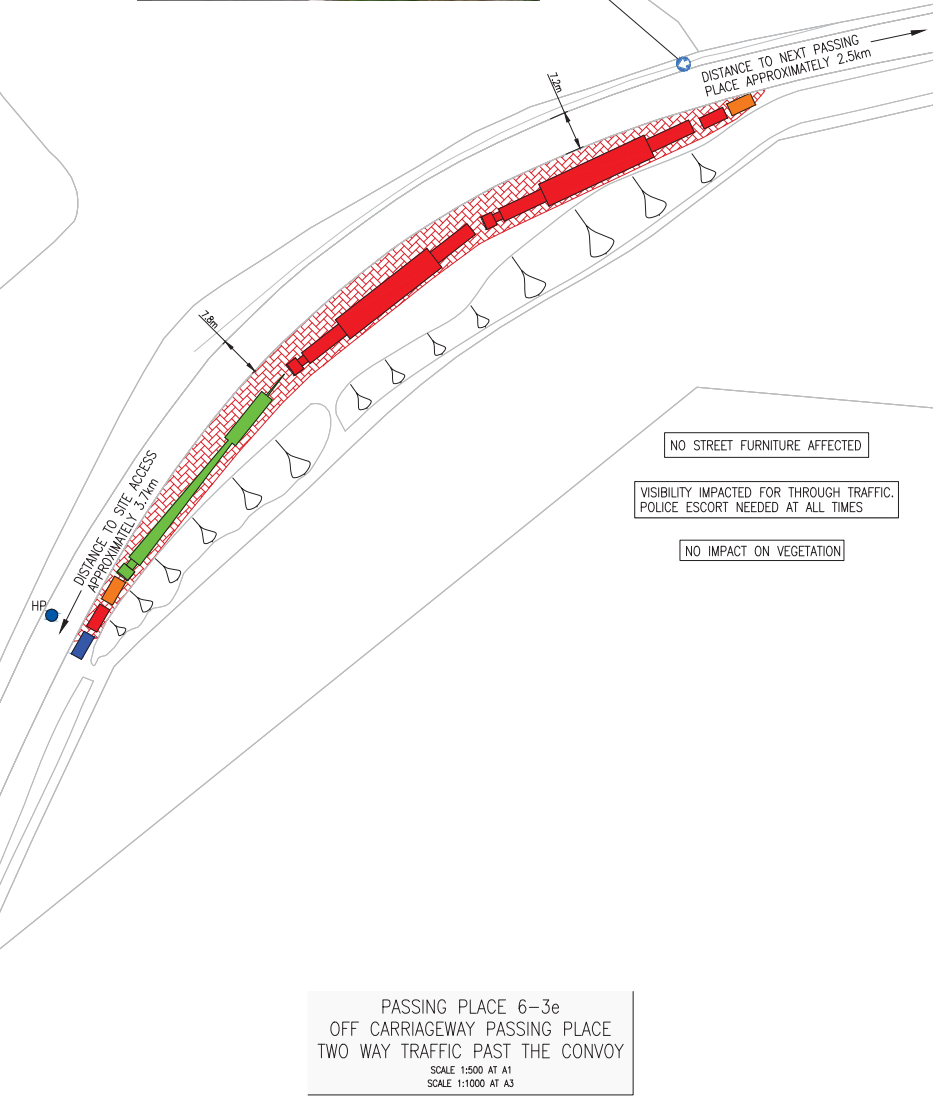

NO STREET FURNITURE AFFECTED

VISIBILITY IMPACTED FOR THROUGH TRAFFIC.  
POLICE ESCORT NEEDED AT ALL TIMES

NO IMPACT ON VEGETATION

PASSING PLACE 6-3e  
OFF CARRIAGEWAY PASSING PLACE  
TWO WAY TRAFFIC PAST THE CONVOY  
SCALE 1:500 AT A1  
SCALE 1:1000 AT A3

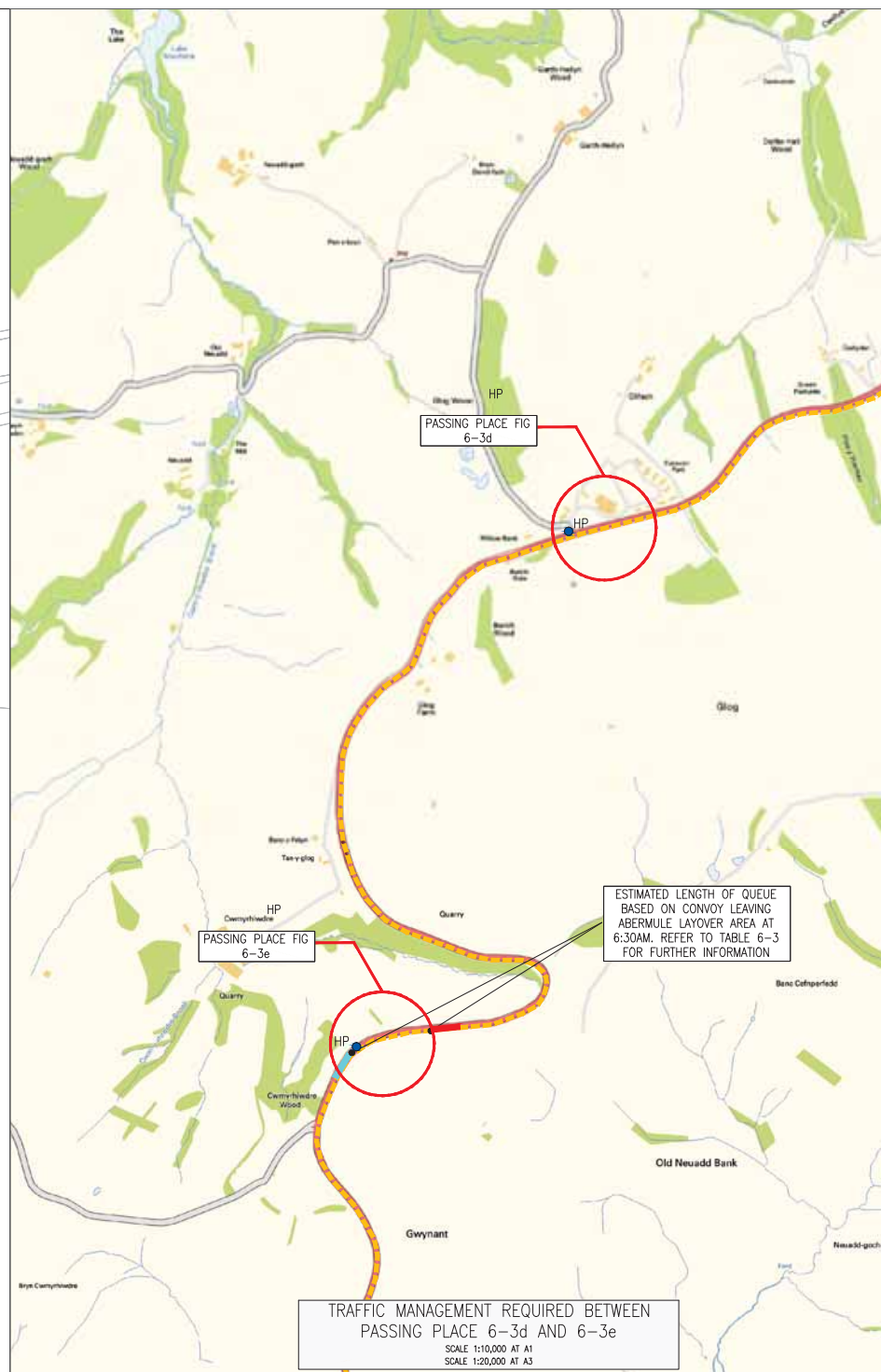

ESTIMATED LENGTH OF QUEUE  
BASED ON CONVOY LEAVING  
ABERMULE LAYOVER AREA AT  
6:30AM. REFER TO TABLE 6-3  
FOR FURTHER INFORMATION

TRAFFIC MANAGEMENT REQUIRED BETWEEN  
PASSING PLACE 6-3d AND 6-3e  
SCALE 1:10,000 AT A1  
SCALE 1:20,000 AT A3

NOTES

- LEGEND
- ROUTE FROM NEWTOWN TO SSA C
  - HP POLICE HOLDING POINT
  - RS ROAD SIGN
  - TP TELEGRAPH POLE
  - [Hatched Box] HARDENED VERGE
  - [Dashed Line] RETAINING STRUCTURE
  - [Blue Line] SAFETY BARRIER
  - [Red Line] ESTIMATED FOLLOWING TRAFFIC QUEUE
  - [Blue Line] ESTIMATED OPPOSING TRAFFIC QUEUE
  - [Blue Arrow] PHOTOGRAPH LOCATION AND DIRECTION
  - [Grey Box] NEW CARRIAGEWAY SURFACE

- VEHICLES LEGEND
- [Red Box] TOWER BASE SECTION VEHICLE
  - [Green Box] 45m BLADE VEHICLE
  - [Orange Box] CIVILIAN ESCORT VEHICLE
  - [Blue Box] POLICE ESCORT VEHICLE
  - [Red Box] BOLLARD REMOVAL/ REPLACEMENT VEHICLE

- NOTES
1. REFER TO FIGURE 1-4a FOR FURTHER INFORMATION ON ASSUMED DELIVERY VEHICLES.
  2. BLADE DELIVERY VEHICLE ASSUMED TO LEAD AS IT WILL SET THE CONVOY SPEED.
  3. ENVIRONMENTAL ASSESSMENT OF PROPOSED WORKS TO BE UNDERTAKEN BY OTHERS.
  4. THE WORKS IDENTIFIED ARE PRELIMINARY SOLUTIONS ONLY. TOPOGRAPHICAL SURVEY OF THE AREA MAY BE REQUIRED PRIOR TO FURTHER DESIGN DEVELOPMENT.
  5. ONSITE MEASUREMENTS TAKEN AT LOCATIONS OF PROPOSED PASSING PLACES.

G	WELSH GOVERNMENT (TRANSPORT DIVISION COMMENTS)	LA	SC	KM	18/12/13
F	WELSH GOVERNMENT (TRANSPORT DIVISION COMMENTS)	JC	SC	KM	17/12/13
E	WELSH GOVERNMENT (TRANSPORT DIVISION COMMENTS)	LA	SC	KM	13/12/13
D	WELSH GOVERNMENT (TRANSPORT DIVISION COMMENTS)	LA	SC	KM	12/12/13
C	CLIENT REVIEW	JC	SC	KM	05/12/13
B	CLIENT REVIEW	DM	SC	KM	20/11/13
A	WORKSHOP COMMENTS	DM	SC	KM	15/11/13
-	FIRST ISSUE	DM	SC	KM	08/11/13
REV	AMENDMENTS	BY	CHKD	APRD	DATE



CLIENT  
**RENEWABLEUK CYMRU**

PROJECT  
**STRATEGIC TRAFFIC MANAGEMENT PLAN FOR MID WALES WIND FARMS**

TITLE  
**FIGURE 6-3e  
PASSING PLACE  
GWYNANT**

STATUS  
**FOR INFORMATION**

DRAWN RT	CHECKED CD	APPROVED SDC
DATE 08.11.13	DATE 08.11.13	DATE 08.11.13
DRAWING SCALE AS SHOWN		ORIGINAL DRAWING SIZE 594 x 841 - A1
DRAWING NO 108526-FIG 6-3e	REV G	



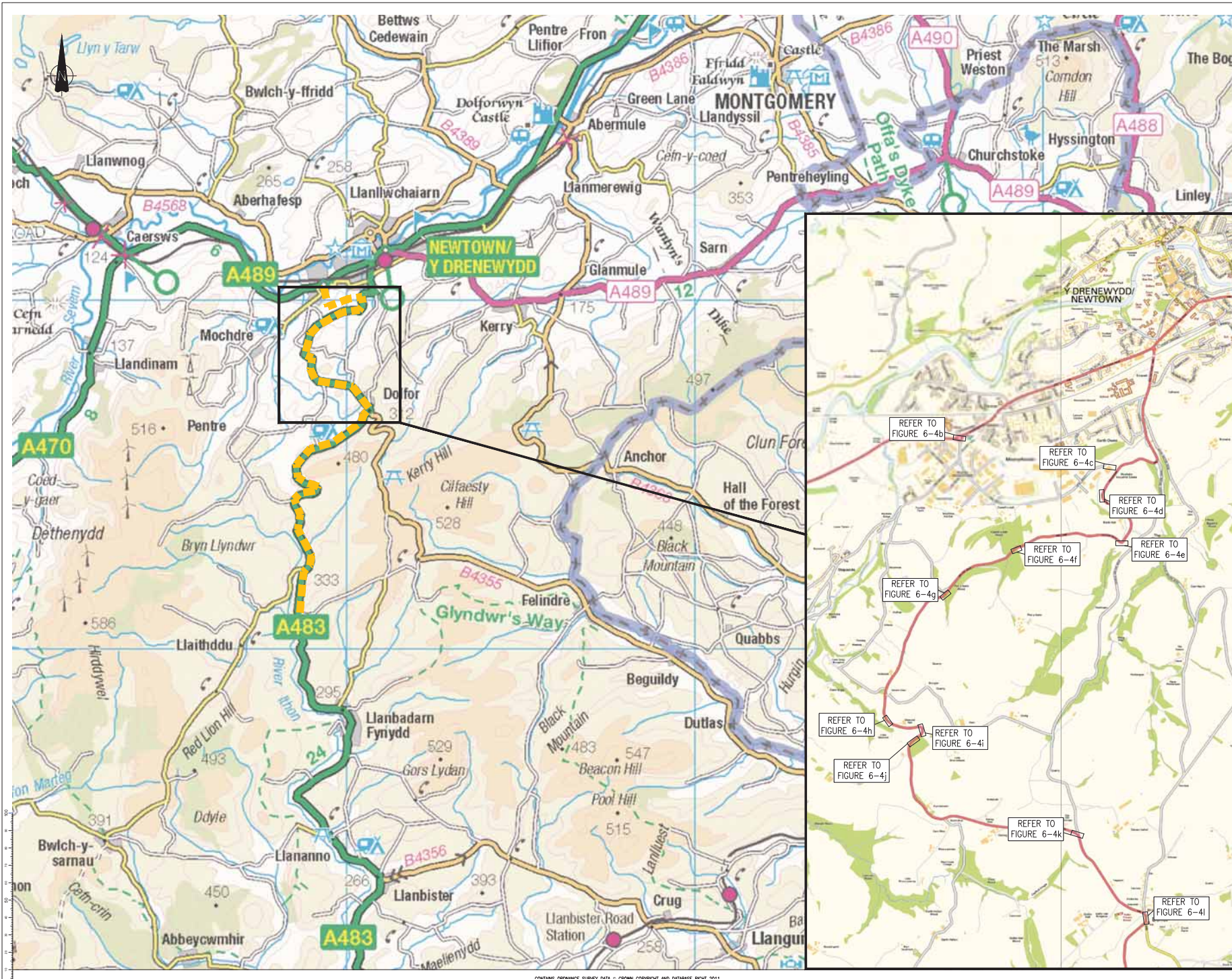

NOTES

LEGEND

ROUTE FROM NEWTOWN TO SSA C



A	WORKSHOP COMMENTS	CD	SDC	KM	15/11/13
-	FIRST ISSUE	CD	SDC	KM	05/11/13
REV	AMENDMENTS	BY	CHKD	APRD	DATE



CLIENT

RENEWABLEUK CYMRU

PROJECT

STRATEGIC TRAFFIC MANAGEMENT PLAN FOR MID WALES WIND FARMS

TITLE

FIGURE 6-4a  
SWEEP PATH ANALYSIS  
OVERVIEW ALONG ROUTE  
FROM NEWTOWN  
TO SSA C

STATUS

FOR INFORMATION

DRAWN	RT	CHECKED	CD	APPROVED	SDC
DATE	05/11/13	DATE	05/11/13	DATE	08/11/13
DRAWING SCALE	NTS			ORIGINAL DRAWING SIZE	594 x 841 - A1
DRAWING NO.	108526-FIG-6-4A			REV.	A

CONTAINS DRAINAGE SURVEY DATA © CROWN COPYRIGHT AND DATABASE RIGHT 2011



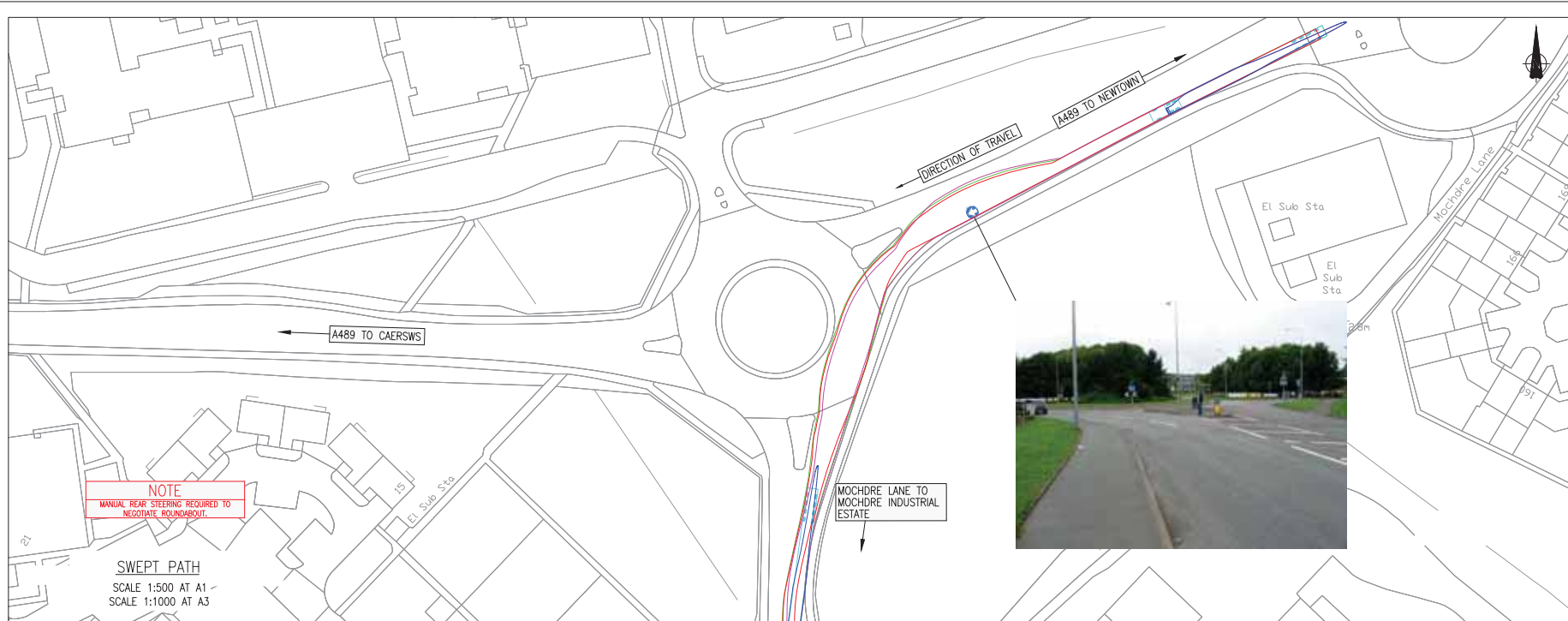

**NOTE**  
MANUAL REAR STEERING REQUIRED TO NEGOTIATE ROUNDABOUT.

**SWEPT PATH**  
SCALE 1:500 AT A1  
SCALE 1:1000 AT A3

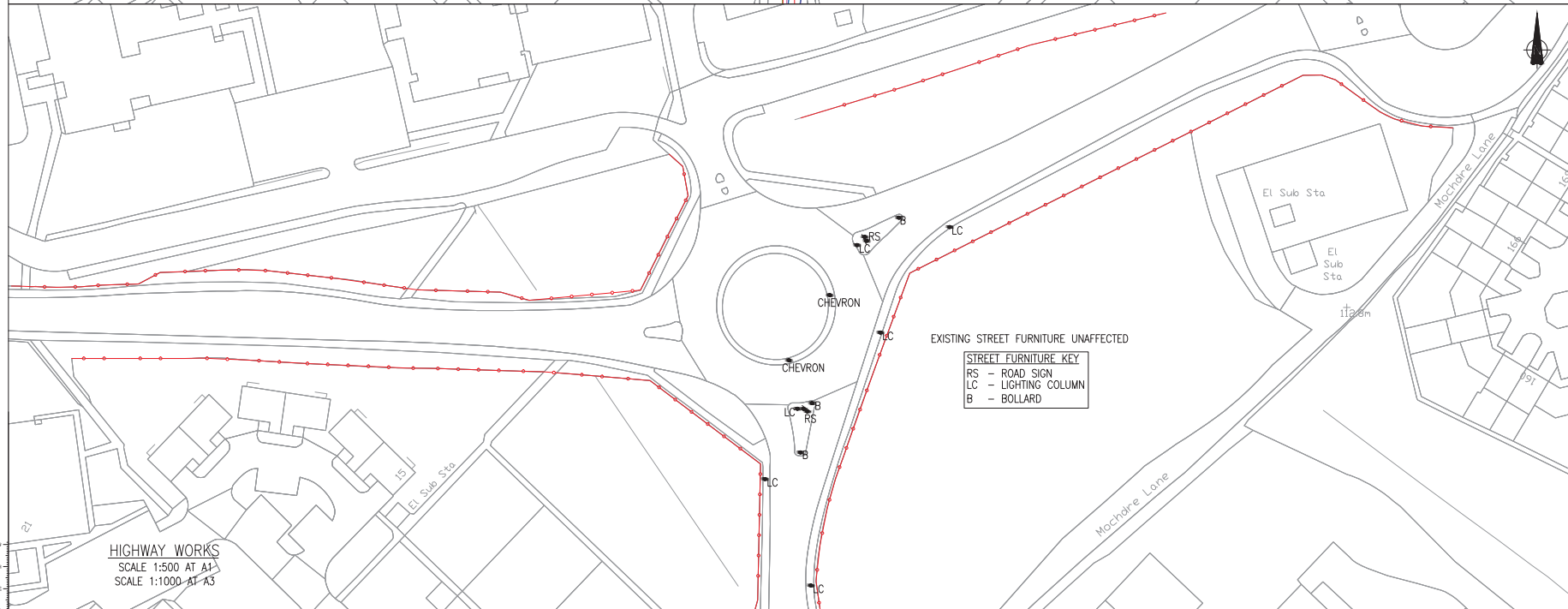

**STREET FURNITURE KEY**  
RS - ROAD SIGN  
LC - LIGHTING COLUMN  
B - BOLLARD

**HIGHWAY WORKS**  
SCALE 1:500 AT A1  
SCALE 1:1000 AT A3

**NOTES**

**KEY:-**

- CHASSIS OVERSAIL
- VEHICLE OUTLINE
- CHASSIS SWEEP-PATH
- LOAD OVERSAIL

- ASSUMED LIMIT OF HIGHWAY LAND
- THIRD PARTY LAND
- EXISTING STREET FURNITURE
- RELOCATED STREET FURNITURE
- PHOTOGRAPH LOCATION AND DIRECTION
- LOAD OVERSAIL ENVELOPE
- CARRIAGEWAY IMPROVEMENT WORKS
- VEHICLE OVER-RUN CONSTRUCTION
- FOOTWAY WORKS
- EARTHWORKS

- NOTES:-**
- AUTOTRACK SWEEP PATH ANALYSIS CARRIED OUT ASSUMING ABNORMAL LOAD ESCORTS ARE PRESENT.
  - VEHICLE USED FOR SWEEP PATH ANALYSIS BASED UPON A 45m BLADE DELIVERY VEHICLE. REFER TO FIGURE 1-4g FOR FURTHER INFORMATION.
  - SWEPT PATH ANALYSIS CARRIED OUT AGAINST ORDNANCE SURVEY AND LOCALISED TOPOGRAPHICAL SURVEY DATA.
  - MANUAL REAR STEERING ONLY DEEMED NECESSARY IF NOTED WITHIN THE HIGHWAY WORKS PLAN.
  - ALL HIGHWAY WORKS HAVE BEEN CREATED ASSUMING AN ADDITIONAL 500mm EXTRA OVER THE AREA OF VEHICLE SWEEP PATH.
  - ENVIRONMENTAL ASSESSMENT OF PROPOSED WORKS TO BE UNDERTAKEN BY OTHERS.

G	WELSH GOVERNMENT (TRANSPORT DIVISION COMMENTS)	LA	SDC	KM	18/12/13
F	WELSH GOVERNMENT (TRANSPORT DIVISION COMMENTS)	JC	SDC	KM	17/12/13
E	WELSH GOVERNMENT (TRANSPORT DIVISION COMMENTS)	LA	SDC	KM	13/12/13
D	WELSH GOVERNMENT (TRANSPORT DIVISION COMMENTS)	LA	SDC	KM	13/12/13
C	CLIENT REVIEW	JC	DM	SC	18/12/13
B	CLIENT REVIEW	CD	DM	SC	20/11/13
A	FIRST ISSUE	CD	DM	SC	15/11/13
REV	AMENDMENTS	BY	CHKD	APRD	DATE



**CLIENT**  
RENEWABLEUK CYMRU

**PROJECT**  
STRATEGIC TRAFFIC MANAGEMENT PLAN FOR MID WALES WIND FARMS

**TITLE**  
FIGURE 6-4b  
SWEPT PATH ANALYSIS  
A489 LLANIDLOES  
ROAD/MOCHDRE LANE  
ROUNDBOUT

**STATUS**  
FOR INFORMATION

DRAWN	RT	CHECKED	DM	APPROVED	KM
DATE	05/11/2013	DATE	08/11/2013	DATE	08/11/2013
DRAWING SCALE	AS SHOWN	ORIGINAL DRAWING SIZE	594 x 841 - A1		
DRAWING NO.	108526-FIG-6-4b				REV.
					G



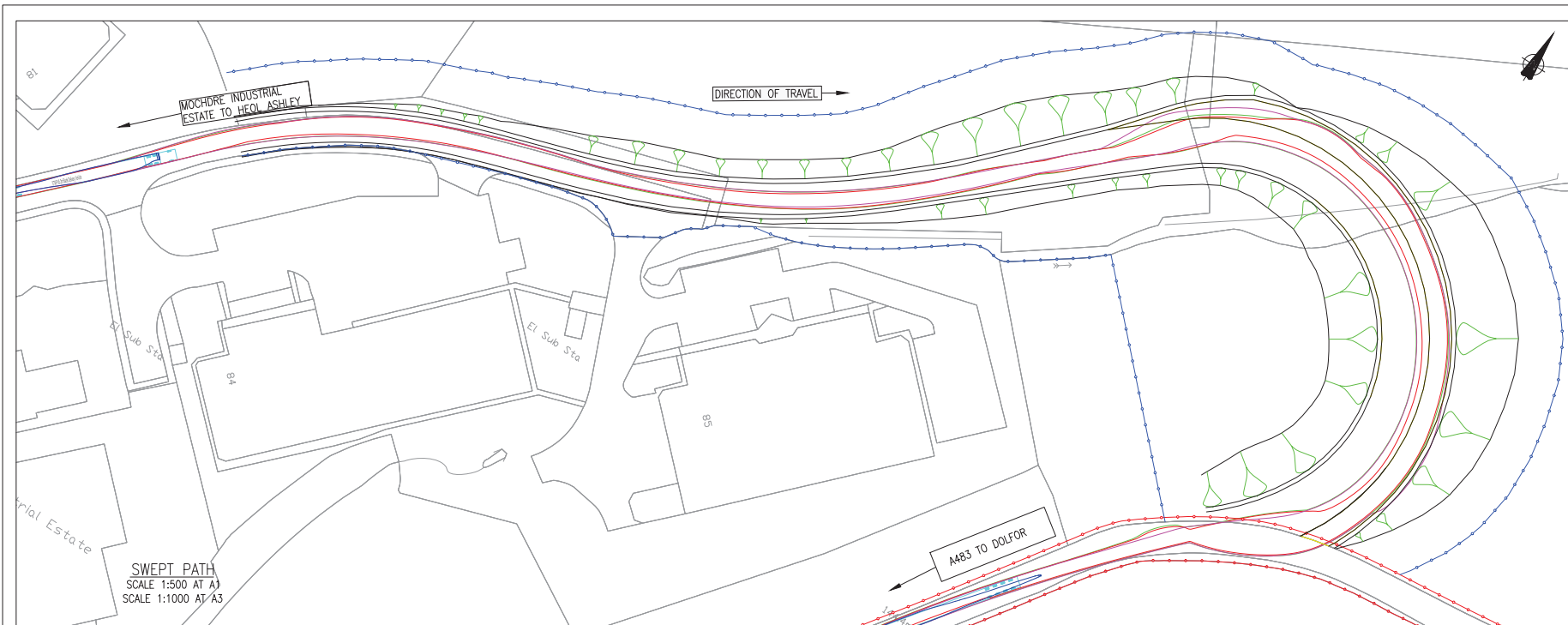

**NOTES**

**KEY:-**

- CHASSIS OVERSAIL
- VEHICLE OUTLINE
- CHASSIS SWEEP-PATH
- LOAD OVERSAIL
- ASSUMED LIMIT OF HIGHWAY LAND
- THIRD PARTY LAND
- EXISTING STREET FURNITURE
- RELOCATED STREET FURNITURE
- PHOTOGRAPH LOCATION AND DIRECTION
- LOAD OVERSAIL ENVELOPE
- CARRIAGEWAY IMPROVEMENT WORKS
- VEHICLE OVER-RUN CONSTRUCTION
- FOOTWAY WORKS
- EARTHWORKS

- NOTES:-**
1. AUTOTRACK SWEEP PATH ANALYSIS CARRIED OUT ASSUMING ABNORMAL LOAD ESCORTS ARE PRESENT.
  2. VEHICLE USED FOR SWEEP PATH ANALYSIS BASED UPON A 45m BLADE DELIVERY VEHICLE. REFER TO FIGURE 1-4a FOR FURTHER INFORMATION.
  3. SWEEP PATH ANALYSIS CARRIED OUT AGAINST ORDNANCE SURVEY AND LOCALISED TOPOGRAPHICAL SURVEY DATA.
  4. MANUAL REAR STEERING ONLY DEEMED NECESSARY IF NOTED WITHIN THE HIGHWAY WORKS PLAN.
  5. ALL HIGHWAY WORKS HAVE BEEN CREATED ASSUMING AN ADDITIONAL 500mm EXTRA OVER THE AREA OF VEHICLE SWEEP PATH.
  6. ENVIRONMENTAL ASSESSMENT OF PROPOSED WORKS TO BE UNDERTAKEN BY OTHERS.

G	WELSH GOVERNMENT (TRANSPORT) DIVISION COMMENTS	LA	SDC	KM	18/12/13
F	WELSH GOVERNMENT (TRANSPORT) DIVISION COMMENTS	JC	SDC	KM	17/12/13
E	WELSH GOVERNMENT (TRANSPORT) DIVISION COMMENTS	LA	SDC	KM	15/12/13
D	WELSH GOVERNMENT (TRANSPORT) DIVISION COMMENTS	LA	SDC	KM	15/12/13
C	CLIENT REVIEW	JC	SC	KM	15/12/13
B	CLIENT REVIEW	DM	SC	KM	10/11/13
A	WORKSHOP COMMENTS	DM	SC	KM	15/11/13
-	FIRST ISSUE	GD	DM	SC	15/11/13
REV	AMENDMENTS	BY	CHKD	APP'D	DATE



CLIENT  
**RENEWABLEUK CYMRU**

PROJECT  
**STRATEGIC TRAFFIC MANAGEMENT PLAN FOR MID WALES WIND FARMS**

TITLE  
**FIGURE 6-4c  
SWEPT PATH ANALYSIS  
MOCHEDRE LINK**

STATUS  
**FOR INFORMATION**

DRAWN	CHKD	APPROVED
DM	DM	KM
DATE	DATE	DATE
05/11/2013	08/11/2013	08/11/2013
DRAWING SCALE	ORIGINAL DRAWING SIZE	
AS SHOWN	594 x 841 - A1	
DRAWING NO.	REV.	
108526-FIG-6-4c	G	





**NOTE**  
MANUAL REAR STEERING REQUIRED TO NEGOTIATE CURVE.

**SWEPT PATH**  
SCALE 1:500 AT A1  
SCALE 1:1000 AT A3

**NOTES**

**KEY:-**

- CHASSIS OVERSAIL
- VEHICLE OUTLINE
- CHASSIS SWEEP-PATH
- LOAD OVERSAIL
- ASSUMED LIMIT OF HIGHWAY LAND
- THIRD PARTY LAND
- EXISTING STREET FURNITURE
- RELOCATED STREET FURNITURE
- PHOTOGRAPH LOCATION AND DIRECTION
- LOAD OVERSAIL ENVELOPE
- CARRAGEWAY IMPROVEMENT WORKS
- VEHICLE OVER-RUN CONSTRUCTION
- FOOTWAY WORKS
- PROPOSED HEDGELINE
- EARTHWORKS

**NOTES:-**

1. AUTOTRACK SWEEP PATH ANALYSIS CARRIED OUT ASSUMING ABNORMAL LOAD ESCORTS ARE PRESENT.
2. VEHICLE USED FOR SWEEP PATH ANALYSIS BASED UPON A 45m BLADE DELIVERY VEHICLE. REFER TO FIGURE 1-4a FOR FURTHER INFORMATION.
3. SWEEP PATH ANALYSIS CARRIED OUT AGAINST ORDINANCE SURVEY AND LOCALISED TOPOGRAPHICAL SURVEY DATA.
4. MANUAL REAR STEERING ONLY DEEMED NECESSARY IF NOTED WITHIN THE HIGHWAY WORKS PLAN.
5. ALL HIGHWAY WORKS HAVE BEEN CREATED ASSUMING AN ADDITIONAL 500mm EXTRA OVER THE AREA OF VEHICLE SWEEP PATH.
6. ENVIRONMENTAL ASSESSMENT OF PROPOSED WORKS TO BE UNDERTAKEN BY OTHERS.

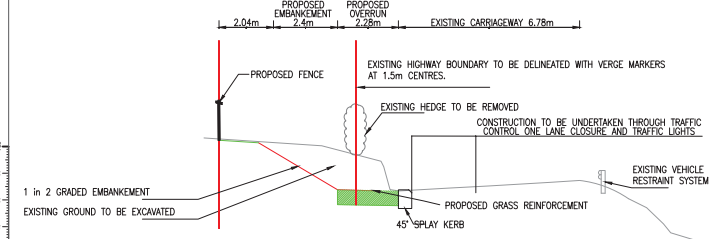
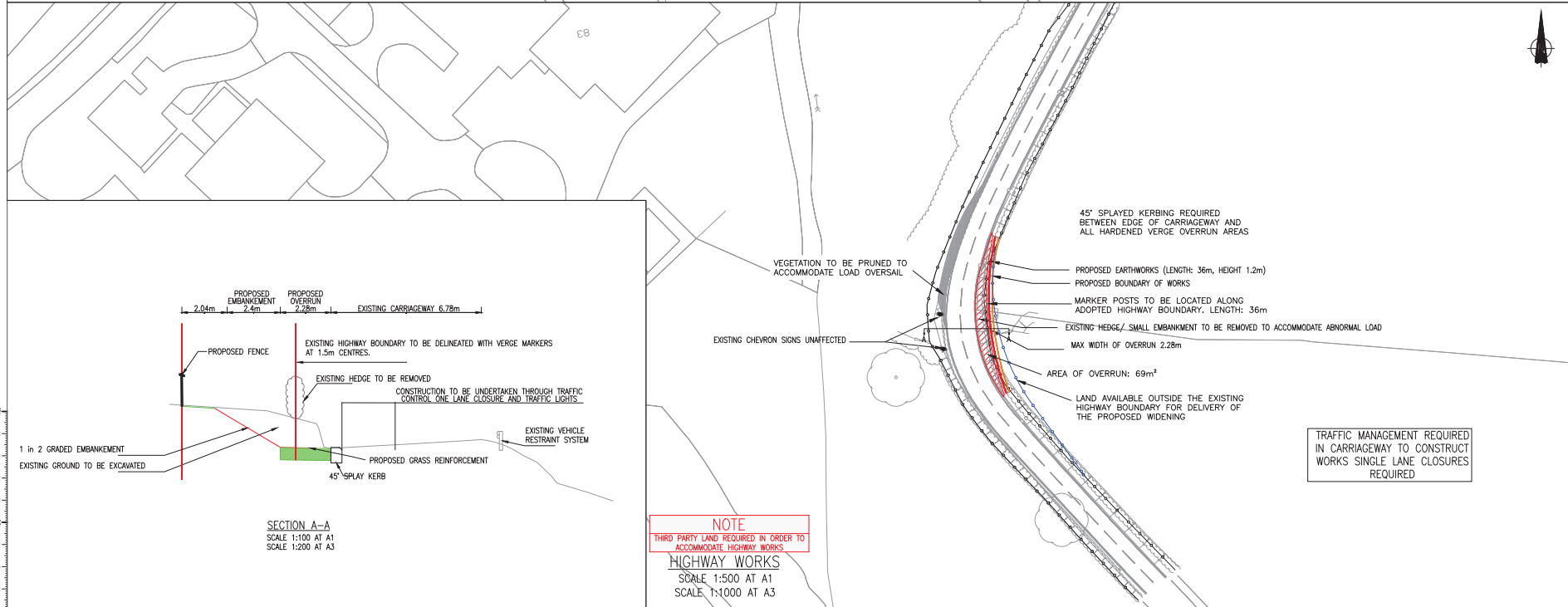

**SECTION A-A**  
SCALE 1:500 AT A1  
SCALE 1:200 AT A3

**NOTE**  
THIRD PARTY LAND REQUIRED IN ORDER TO ACCOMMODATE HIGHWAY WORKS

**HIGHWAY WORKS**  
SCALE 1:500 AT A1  
SCALE 1:1000 AT A3

TRAFFIC MANAGEMENT REQUIRED IN CARRAGEWAY TO CONSTRUCT WORKS SINGLE LANE CLOSURES REQUIRED

- NOTES:-**
1. AUTOTRACK SWEEP PATH ANALYSIS CARRIED OUT ASSUMING ABNORMAL LOAD ESCORTS ARE PRESENT.
  2. VEHICLE USED FOR SWEEP PATH ANALYSIS BASED UPON A 45m BLADE DELIVERY VEHICLE. REFER TO FIGURE 1-4a FOR FURTHER INFORMATION.
  3. SWEEP PATH ANALYSIS CARRIED OUT AGAINST ORDINANCE SURVEY AND LOCALISED TOPOGRAPHICAL SURVEY DATA.
  4. MANUAL REAR STEERING ONLY DEEMED NECESSARY IF NOTED WITHIN THE HIGHWAY WORKS PLAN.
  5. ALL HIGHWAY WORKS HAVE BEEN CREATED ASSUMING AN ADDITIONAL 500mm EXTRA OVER THE AREA OF VEHICLE SWEEP PATH.
  6. ENVIRONMENTAL ASSESSMENT OF PROPOSED WORKS TO BE UNDERTAKEN BY OTHERS.

REV	AMENDMENTS	BY	CHKD	APPRD	DATE
H	WELSH GOVERNMENT (TRANSPORT DIVISION) COMMENTS	JC	SDC	KM	16/12/13
G	WELSH GOVERNMENT (TRANSPORT DIVISION) COMMENTS	LA	SDC	KM	16/12/13
F	WELSH GOVERNMENT (TRANSPORT DIVISION) COMMENTS	JC	SDC	KM	17/12/13
E	WELSH GOVERNMENT (TRANSPORT DIVISION) COMMENTS	LA	SDC	KM	13/12/13
D	WELSH GOVERNMENT (TRANSPORT DIVISION) COMMENTS	LA	SDC	KM	12/12/13
C	CLIENT REVIEW	JC	SC	KM	05/12/13
B	CLIENT REVIEW	DM	SC	KM	20/11/13
A	WORKSHOP COMMENTS	CD	SDC	KM	15/11/13
-	FIRST ISSUE	CD	DM	SC	08/11/13



CLIENT  
**RENEWABLEUK CYMRU**

PROJECT  
**STRATEGIC TRAFFIC MANAGEMENT PLAN FOR MID WALES WIND FARMS**

TITLE  
**FIGURE 6-4d  
SWEPT PATH ANALYSIS  
A483 SOUTH OF NEWTOWN**

STATUS  
**FOR INFORMATION**

DRAWN	CHECKED	APPROVED
RT	DM	KM
DATE	DATE	DATE
05/11/2013	08/11/2013	08/11/2013
DRAWING SCALE	ORIGINAL DRAWING SIZE	
AS SHOWN	594 x 841 - A1	

DRAWING NO: **108526-FIG-6-4d** REV: **H**





REINFORCED EARTH DETAIL



**NOTE**  
MANUAL REAR STEERING REQUIRED TO NEGOTIATE CURVE.

**SWEEP PATH**  
SCALE 1:500 AT A1  
SCALE 1:1000 AT A3

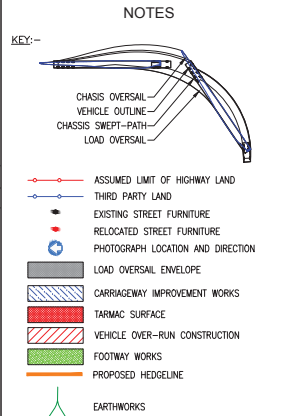

- NOTES:-**
1. AUTOTRACK SWEEP PATH ANALYSIS CARRIED OUT ASSUMING ABNORMAL LOAD ESCORTS ARE PRESENT.
  2. VEHICLE USED FOR SWEEP PATH ANALYSIS BASED UPON A 45m BLADE DELIVERY VEHICLE. REFER TO FIGURE 1-4a FOR FURTHER INFORMATION.
  3. SWEEP PATH ANALYSIS CARRIED OUT AGAINST ORDNANCE SURVEY AND LOCALISED TOPOGRAPHICAL SURVEY DATA.
  4. MANUAL REAR STEERING ONLY DEEMED NECESSARY IF NOTED WITHIN THE HIGHWAY WORKS PLAN.
  5. ALL HIGHWAY WORKS HAVE BEEN CREATED ASSUMING AN ADDITIONAL 500mm EXTRA OVER THE AREA OF VEHICLE SWEEP PATH.
  6. ENVIRONMENTAL ASSESSMENT OF PROPOSED WORKS TO BE UNDERTAKEN BY OTHERS.

REV	AMENDMENTS	BY	CHKD	APPRD	DATE
G	WELSH GOVERNMENT (TRANSPORT DIVISION) COMMENTS	JC	SC	MM	18/12/13
F	WELSH GOVERNMENT (TRANSPORT DIVISION) COMMENTS	JA	SC	MM	18/12/13
E	WELSH GOVERNMENT (TRANSPORT DIVISION) COMMENTS	JC	SC	MM	17/12/13
D	WELSH GOVERNMENT (TRANSPORT DIVISION) COMMENTS	JA	SC	MM	13/12/13
C	WELSH GOVERNMENT (TRANSPORT DIVISION) COMMENTS	JC	SC	MM	12/12/13
B	CLIENT REVIEW	DM	SC	MM	20/11/13
A	WORKSHOP COMMENTS	CD	SC	MM	05/11/13
-	FIRST ISSUE	CD	DM	SC	08/11/13



CLIENT  
**RENEWABLEUK CYMRU**

PROJECT  
**STRATEGIC TRAFFIC MANAGEMENT PLAN FOR MID WALES WIND FARMS**

TITLE  
**FIGURE 6-4e SWEEP PATH ANALYSIS A483 SOUTH OF BLACK HALL FARM**

STATUS  
**FOR INFORMATION**

DRAWN	CHECKED	APPROVED
RT	DM	KM
DATE 05/11/2013	DATE 08/11/2013	DATE 08/11/2013
DRAWING SCALE ORIGINAL DRAWING SIZE		
AS SHOWN 594 x 841 - A1		

DRAWING NO. **108526-FIG-6-4e** REV. **G**

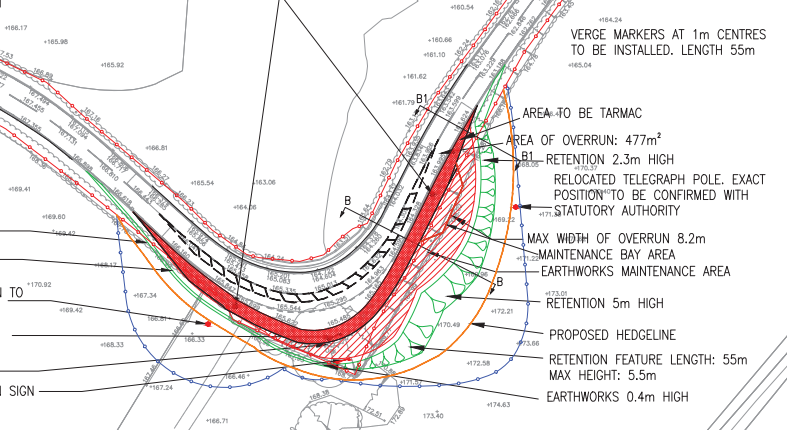
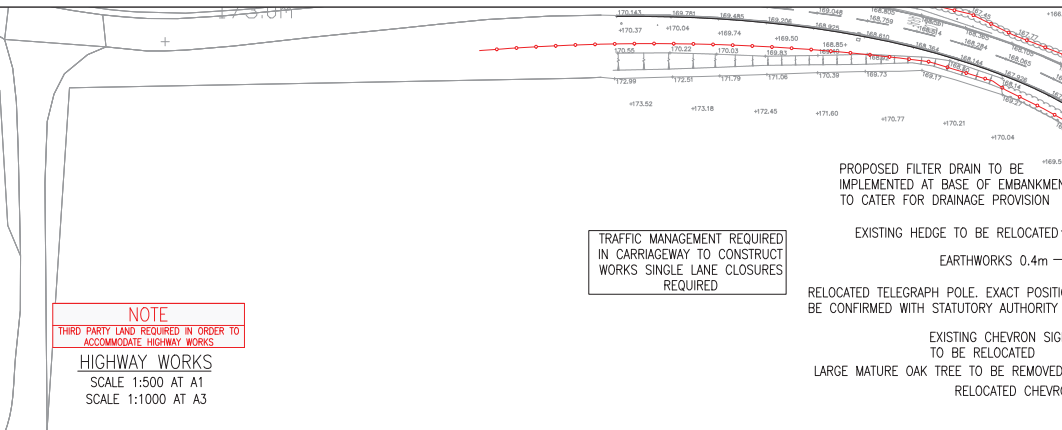
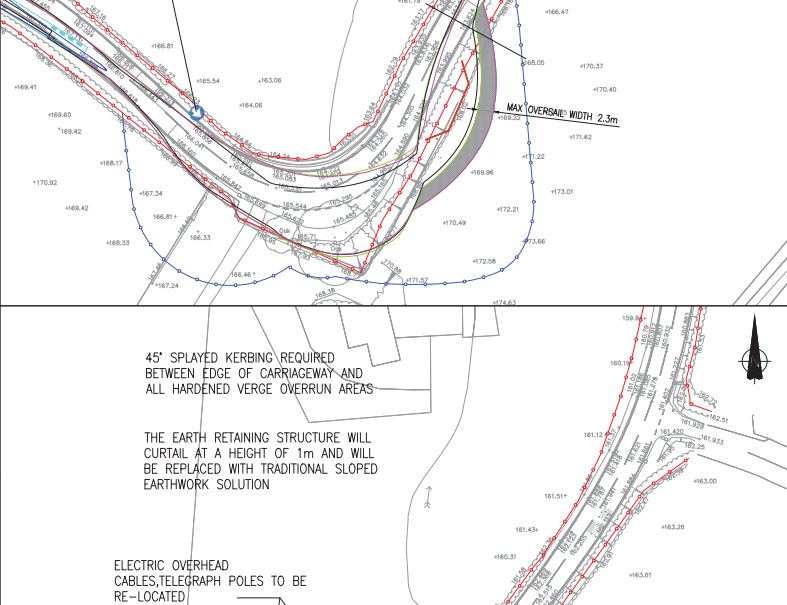
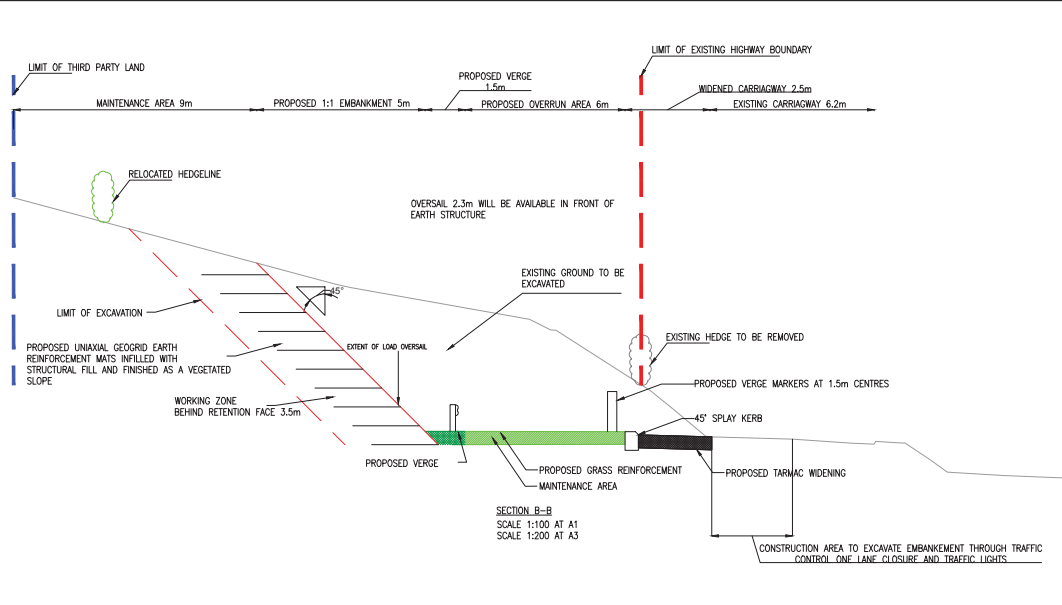

**NOTE**  
THIRD PARTY LAND REQUIRED IN ORDER TO ACCOMMODATE HIGHWAY WORKS  
**HIGHWAY WORKS**  
SCALE 1:500 AT A1  
SCALE 1:1000 AT A3

**TRAFFIC MANAGEMENT REQUIRED IN CARRIAGEWAY TO CONSTRUCT WORKS SINGLE LANE CLOSURES REQUIRED**

PROPOSED FILTER DRAIN TO BE IMPLEMENTED AT BASE OF EMBANKMENT TO CATER FOR DRAINAGE PROVISION

EXISTING HEDGE TO BE RELOCATED

EARTHWORKS 0.4m

RELOCATED TELEGRAPH POLE. EXACT POSITION TO BE CONFIRMED WITH STATUTORY AUTHORITY

EXISTING CHEVRON SIGN TO BE RELOCATED

LARGE MATURE OAK TREE TO BE REMOVED

RELOCATED CHEVRON SIGN



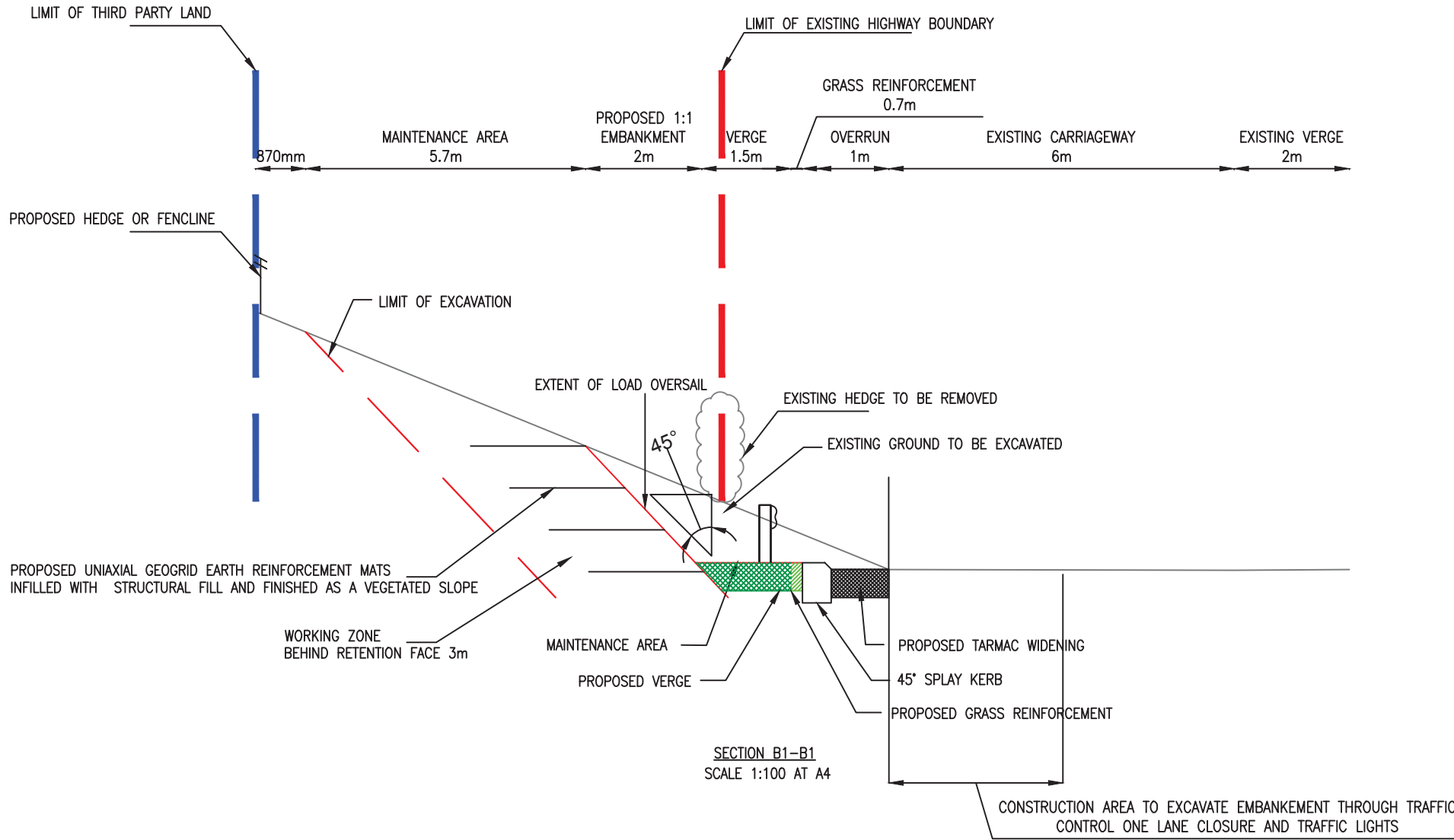

DRG Path: F:\PROJECTS\Development - Gairreg Lwyd\03 EXECUTION\DWGS\AECOM\IP1108526-FIG 6 4e REV G.dwg  
 Layout Tab: Layout2 • User: CRAI\IP10NJ Plot time: 19/12/2013 @ 4:30 PM

Client: <b>RENEWABLEUK CYMRU</b>	Title: <b>A483 SOUTH OF BLACK HALL FARM - SECTION A</b>	 5th Floor, 2 City Walk LEEDS, LS11 9AR Tel: +44 (0) 113 391 6800 Fax: +44 (0) 113 391 6899 www.aecom.com	Design: SDC	CAD: JC	<b>cm</b>
Project: <b>STMP FOR MID WALES WIND FARMS</b>			Chk'd: SDC	App'd: SDC	
			Date: 19/12/2013	Scale: 1:100	
<b>No. FIGURE 001</b>				Rev: --	





NOTES

KEY:-

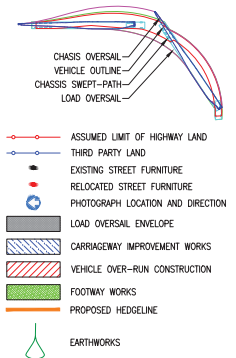

NOTES:-

1. AUTOTRACK SWEEP PATH ANALYSIS CARRIED OUT ASSUMING ABNORMAL LOAD ESCORTS ARE PRESENT.
2. VEHICLE USED FOR SWEEP PATH ANALYSIS BASED UPON A 45m BLADE DELIVERY VEHICLE. REFER TO FIGURE 1-4g FOR FURTHER INFORMATION.
3. SWEEP PATH ANALYSIS CARRIED OUT AGAINST ORDNANCE SURVEY AND LOCALISED TOPOGRAPHICAL SURVEY DATA.
4. MANUAL REAR STEERING ONLY DEEMED NECESSARY IF NOTED WITHIN THE HIGHWAY WORKS PLAN.
5. ALL HIGHWAY WORKS HAVE BEEN CREATED ASSUMING AN ADDITIONAL 500mm EXTRA OVER THE AREA OF VEHICLE SWEEP PATH.
6. ENVIRONMENTAL ASSESSMENT OF PROPOSED WORKS TO BE UNDERTAKEN BY OTHERS.

F	WELSH GOVERNMENT (TRANSPORT DIVISION) COMMENTS	LA	SDC	KM	18/12/13
E	WELSH GOVERNMENT (TRANSPORT DIVISION) COMMENTS	JC	SDC	KM	17/12/13
D	WELSH GOVERNMENT (TRANSPORT DIVISION) COMMENTS	LA	SDC	KM	13/12/13
C	WELSH GOVERNMENT (TRANSPORT DIVISION) COMMENTS	LA	SDC	KM	13/12/13
B	CLIENT REVIEW	CD	SDC	KM	08/12/13
A	WORKSHOP COMMENTS	CD	SDC	KM	15/11/13
-	FIRST ISSUE	CD	DM	SC	18/11/13
REV	AMENDMENTS	BY	CHKD	APPD	DATE



CLIENT  
**RENEWABLEUK CYMRU**

PROJECT  
**STRATEGIC TRAFFIC MANAGEMENT PLAN FOR MID WALES WIND FARMS**

TITLE  
**FIGURE 6-4f SWEEP PATH ANALYSIS A483 CASTELL-Y-DAIL WOOD**

STATUS  
**FOR INFORMATION**

DRAWN	RT	CHECKED	DM	APPROVED	KM
DATE	05/11/2013	DATE	08/11/2013	DATE	08/11/2013
DRAWING SCALE	AS SHOWN	ORIGINAL DRAWING SIZE	594 x 841 - A1		
DRAWING NO.	108526-FIG-6-4f	REV.	F		

**NOTE**  
MANUAL REAR STEERING REQUIRED TO NEGOTIATE CURVE.

**SWEPT PATH**  
SCALE 1:500 AT A1  
SCALE 1:1000 AT A3

HIGHWAY IMPROVEMENTS ACCOMMODATE THE SWEEP PATH OF THE DELIVERY VEHICLES USING MANUAL REAR STEERING.

THIRD PARTY LAND REQUIRED OUTSIDE THE HIGHWAY BOUNDARY TO CONSTRUCT THE HIGHWAY WORKS

EXISTING HEDGELINE TO BE RELOCATED AND ALONG EXISTING ADOPTION LINE REPLACED WITH BOUNDARY FENCE SUITABLE FOR OVERSAIL

FENCELINE TO BE LOCATED ON EXISTING BOUNDARY LINE, HEIGHT SUITABLE FOR OVERSAIL

0.8m FULL CARRIAGEWAY CONSTRUCTION WIDENING BOUNDED BY 45° SPLAY KERB WITH ADDITIONAL WORKING SPACE OF 2.2m FOR OVERSAIL AREA WORKING

WIDENING MAX 2.1m WITH FURTHER 1.65m TO REDLINE BOUNDARY FOR WORK AREA TO FORM OVERSAIL

THIRD PARTY LAND REQUIRED OUTSIDE THE HIGHWAY BOUNDARY TO CONSTRUCT THE HIGHWAY WORKS

HEDGE TO BE RELOCATED

PROPOSED RELOCATED HEDGE

TRAFFIC MANAGEMENT REQUIRED IN CARRIAGEWAY TO CONSTRUCT WORKS SINGLE LANE CLOSURES REQUIRED

**NOTE**  
THIRD PARTY LAND REQUIRED IN ORDER TO ACCOMMODATE HIGHWAY WORKS

**HIGHWAY WORKS**  
SCALE 1:500 AT A1  
SCALE 1:1000 AT A3





**NOTES**

**KEY:-**

- CHASSIS OVERSAIL
- VEHICLE OUTLINE
- CHASSIS SWEEP-PATH
- LOAD OVERSAIL

- ASSUMED LIMIT OF HIGHWAY LAND
- THIRD PARTY LAND
- EXISTING STREET FURNITURE
- RELOCATED STREET FURNITURE
- PHOTOGRAPH LOCATION AND DIRECTION
- LOAD OVERSAIL ENVELOPE
- CARRIAGEWAY IMPROVEMENT WORKS
- VEHICLE OVER-RUN CONSTRUCTION
- FOOTWAY WORKS
- EARTHWORKS

- NOTES:-**
- AUTOTRACK SWEEP PATH ANALYSIS CARRIED OUT ASSUMING ABNORMAL LOAD ESCORTS ARE PRESENT.
  - VEHICLE USED FOR SWEEP PATH ANALYSIS BASED UPON A 45m BLADE DELIVERY VEHICLE. REFER TO FIGURE 1-4g FOR FURTHER INFORMATION.
  - SWEEP PATH ANALYSIS CARRIED OUT AGAINST ORDNANCE SURVEY AND LOCALISED TOPOGRAPHICAL SURVEY DATA.
  - MANUAL REAR STEERING ONLY DEEMED NECESSARY IF NOTED WITHIN THE HIGHWAY WORKS PLAN.
  - ALL HIGHWAY WORKS HAVE BEEN CREATED ASSUMING AN ADDITIONAL 500mm EXTRA OVER THE AREA OF VEHICLE SWEEP PATH.
  - ENVIRONMENTAL ASSESSMENT OF PROPOSED WORKS TO BE UNDERTAKEN BY OTHERS.

REV	AMENDMENTS	BY	CHKD	APPRD	DATE
G	WELSH GOVERNMENT (TRANSPORT DIVISION) COMMENTS	JC	SDC	KM	10/12/13
F	WELSH GOVERNMENT (TRANSPORT DIVISION) COMMENTS	LA	SDC	KM	18/12/13
E	WELSH GOVERNMENT (TRANSPORT DIVISION) COMMENTS	JC	SDC	KM	17/12/13
D	WELSH GOVERNMENT (TRANSPORT DIVISION) COMMENTS	LA	SDC	KM	13/12/13
C	WELSH GOVERNMENT (TRANSPORT DIVISION) COMMENTS	LA	SDC	KM	12/12/13
B	CLIENT REVIEW	JC	SC	KM	08/12/13
A	WORKSHOP COMMENTS	DM	SC	KM	12/11/13
-	FIRST ISSUE	CD	CM	SC	08/11/13



CLIENT  
**RENEWABLEUK CYMRU**

PROJECT  
**STRATEGIC TRAFFIC MANAGEMENT PLAN FOR MID WALES FARM WIND FARMS**

TITLE  
**FIGURE 6-4g SWEEP PATH ANALYSIS A483 PEN-Y-BANC WOOD**

STATUS  
**FOR INFORMATION**

DRAWN	CHECKED	APPROVED
RT	DM	KM
DATE	DATE	DATE
05/11/2013	08/11/2013	08/11/2013
DRAWING SCALE	ORIGINAL DRAWING SIZE	
AS SHOWN	594 x 841 - A1	

DRAWING NO: **108526-FIG-6-4g** REV: **G**

SWEEP PATH  
SCALE 1:500 AT A1  
SCALE 1:1000 AT A3

TELEGRAPH POLE TO BE RE-LOCATED  
RE-LOCATED TELEGRAPH POLES, EXACT POSITIONS TO BE CONFIRMED BY STATUTORY AUTHORITY.

**NOTE**  
THIRD PARTY LAND REQUIRED IN ORDER TO ACCOMMODATE HIGHWAY WORKS

HIGHWAY WORKS  
SCALE 1:500 AT A1  
SCALE 1:1000 AT A3

AREA OF OVERRUN: 100m<sup>2</sup>

TRAFFIC MANAGEMENT REQUIRED IN CARRIAGEWAY TO CONSTRUCT WORKS SINGLE LANE CLOSURES REQUIRED

OVERRUN TO BE ACCOMMODATED WITHIN THE EXISTING HIGHWAY VERGE. NO EARTHWORKS REQUIRED

HEDGE TO BE REMOVED

THIRD PARTY LAND REQUIRED OUTSIDE THE HIGHWAY BOUNDARY TO CONSTRUCT THE HIGHWAY WORKS. NEW FENCELINE PROVIDED TO REPLACE

EXISTING BOUNDARY TO BE REPLACED WITH MARKER POSTS. LENGTH: 10m

HEDGE TO BE PRUNED

MAX WIDTH OF OVERRUN 0,75m

MAX WIDTH OF OVERRUN 0.8m

MAINTENANCE BAY AREA

MAX WIDTH OF OVERRUN 0.5m

HEDGE TO BE REMOVED AND RELOCATED

PROPOSED RELOCATED HEDGE. LINE OF ADOPTION REPLACED WITH MARKER POSTS. LENGTH: 15m

EXISTING ROAD SIGN UNAFFECTED

211.8m

209.9m

206.0m

206.0m

209.9m

DIRECTION OF TRAVEL

A483 TO DOLFOR

A483 TO NEWTOWN





SWEPT PATH  
SCALE 1:500 AT A1  
SCALE 1:1000 AT A3

**NOTE**  
THIRD PARTY LAND REQUIRED IN ORDER TO  
ACCOMMODATE HIGHWAY WORKS  
HIGHWAY WORKS  
SCALE 1:500 AT A1  
SCALE 1:1000 AT A3

TRAFFIC MANAGEMENT REQUIRED  
IN CARRIAGEWAY TO CONSTRUCT  
WORKS SINGLE LANE CLOSURES  
REQUIRED

AREA OF OVERRUN: 5m<sup>2</sup>

THIRD PARTY LAND REQUIRED OUTSIDE THE HIGHWAY  
BOUNDARY TO CONSTRUCT THE HIGHWAY WORKS

45° SPLAYED KERBING REQUIRED BETWEEN  
EDGE OF CARRIAGEWAY AND ALL HARDENED  
VERGE OVERRUN AREAS

HEDGE TO BE RELOCATED TO NEW BOUNDARY  
LENGTH 66.8m

RELOCATED TELEGRAPH POLE, EXACT POSITION  
TO BE CONFIRMED BY STATUTORY AUTHORITY.

TELEGRAPH POLE TO BE RELOCATED  
HEDGE TO BE REMOVED AND REPLACED  
WITH PERMANENT BOLLARDS

MAX WIDTH OF OVERRUN 0.3m

**NOTES**

KEY:-

- ASSUMED LIMIT OF HIGHWAY LAND
- THIRD PARTY LAND
- EXISTING STREET FURNITURE
- RELOCATED STREET FURNITURE
- PHOTOGRAPH LOCATION AND DIRECTION
- LOAD OVERSAIL ENVELOPE
- CARRIAGEWAY IMPROVEMENT WORKS
- VEHICLE OVER-RUN CONSTRUCTION
- FOOTWAY WORKS
- PROPOSED HEDGELINE
- EARTHWORKS

- NOTES:-**
- AUTOTRACK SWEEP PATH ANALYSIS CARRIED OUT ASSUMING ABNORMAL LOAD ESCORTS ARE PRESENT.
  - VEHICLE USED FOR SWEEP PATH ANALYSIS BASED UPON A 45m BLADE DELIVERY VEHICLE. REFER TO FIGURE 1-4g FOR FURTHER INFORMATION.
  - SWEEP PATH ANALYSIS CARRIED OUT AGAINST ORDNANCE SURVEY AND LOCALISED TOPOGRAPHICAL SURVEY DATA.
  - MANUAL REAR STEERING ONLY DEEMED NECESSARY IF NOTED WITHIN THE HIGHWAY WORKS PLAN.
  - ALL HIGHWAY WORKS HAVE BEEN CREATED ASSUMING AN ADDITIONAL 500mm EXTRA OVER THE AREA OF VEHICLE SWEEP PATH.
  - ENVIRONMENTAL ASSESSMENT OF PROPOSED WORKS TO BE UNDERTAKEN BY OTHERS.

F	WELSH GOVERNMENT (TRANSPORT DIVISION) COMMENTS	LA	SDC	KM	18/12/13
E	WELSH GOVERNMENT (TRANSPORT DIVISION) COMMENTS	JC	SDC	KM	17/12/13
D	WELSH GOVERNMENT (TRANSPORT DIVISION) COMMENTS	LA	SDC	KM	13/12/13
C	WELSH GOVERNMENT (TRANSPORT DIVISION) COMMENTS	JC	SDC	KM	13/12/13
B	CLIENT REVIEW	JC	SDC	KM	06/12/13
A	WORKSHOP COMMENTS	CD	SDC	KM	15/11/13
*	FIRST ISSUE	CD	DM	SC	15/11/13
REV	AMENDMENTS	BY	CHKD	APRD	DATE



CLIENT  
**RENEWABLEUK CYMRU**

PROJECT  
**STRATEGIC TRAFFIC  
MANAGEMENT PLAN FOR  
MID WALES WIND FARMS**

TITLE  
**FIGURE 6-4h  
SWEPT PATH ANALYSIS  
A483 WEST OF GLASCOED  
HALL**

STATUS  
**FOR INFORMATION**

DRAWN RT	CHECKED DM	APPROVED KM
DATE 05/11/2013	DATE 08/11/2013	DATE 08/11/2013
DRAWING SCALE AS SHOWN	ORIGINAL DRAWING SIZE 594 x 841 - A1	

DRAWING NO.  
**108526-FIG-6-4h**

REV.  
**F**





SWEPT PATH  
SCALE 1:500 AT A1  
SCALE 1:1000 AT A3

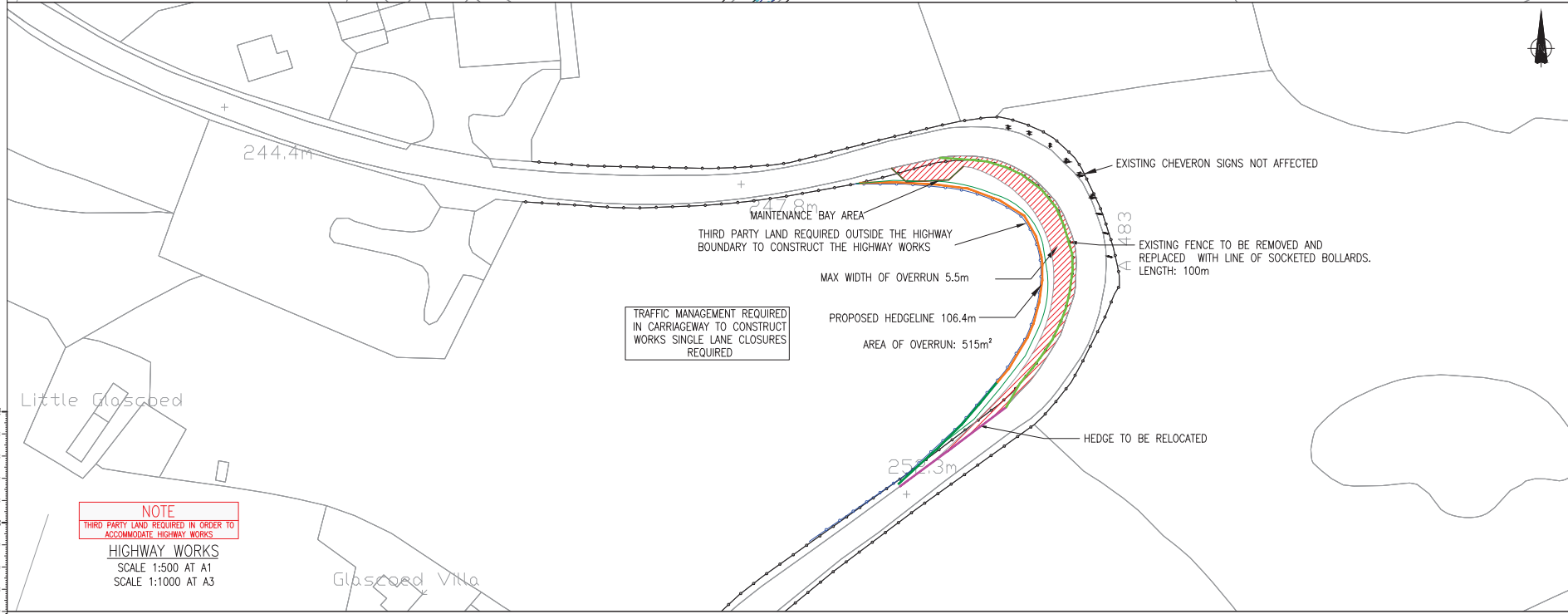

**NOTE**  
THIRD PARTY LAND REQUIRED IN ORDER TO ACCOMMODATE HIGHWAY WORKS  
**HIGHWAY WORKS**  
SCALE 1:500 AT A1  
SCALE 1:1000 AT A3

**NOTES**

**KEY:-**

- CHASSIS OVERSAIL
- VEHICLE OUTLINE
- CHASSIS SWEEP-PATH
- LOAD OVERSAIL
- ASSUMED LIMIT OF HIGHWAY LAND
- THIRD PARTY LAND
- EXISTING STREET FURNITURE
- RELOCATED STREET FURNITURE
- PHOTOGRAPH LOCATION AND DIRECTION
- CARRIAGEWAY IMPROVEMENT WORKS
- VEHICLE OVER-RUN CONSTRUCTION
- FOOTWAY WORKS
- PROPOSED HEDGELINE
- EXISTING FENCE TO BE REMOVED
- EARTHWORKS

**NOTES:-**

- AUTOTRACK SWEEP PATH ANALYSIS CARRIED OUT ASSUMING ABNORMAL LOAD ESCORTS ARE PRESENT.
- VEHICLE USED FOR SWEEP PATH ANALYSIS BASED UPON A 45m BLADE DELIVERY VEHICLE. REFER TO FIGURE 1-4g FOR FURTHER INFORMATION.
- SWEEP PATH ANALYSIS CARRIED OUT AGAINST ORDINANCE SURVEY AND LOCALISED TOPOGRAPHICAL SURVEY DATA.
- MANUAL REAR STEERING ONLY DEEMED NECESSARY IF NOTED WITHIN THE HIGHWAY WORKS PLAN.
- ALL HIGHWAY WORKS HAVE BEEN CREATED ASSUMING AN ADDITIONAL 500mm EXTRA OVER THE AREA OF VEHICLE SWEEP PATH.
- ENVIRONMENTAL ASSESSMENT OF PROPOSED WORKS TO BE UNDERTAKEN BY OTHERS.

- NOTES:-**
- AUTOTRACK SWEEP PATH ANALYSIS CARRIED OUT ASSUMING ABNORMAL LOAD ESCORTS ARE PRESENT.
  - VEHICLE USED FOR SWEEP PATH ANALYSIS BASED UPON A 45m BLADE DELIVERY VEHICLE. REFER TO FIGURE 1-4g FOR FURTHER INFORMATION.
  - SWEEP PATH ANALYSIS CARRIED OUT AGAINST ORDINANCE SURVEY AND LOCALISED TOPOGRAPHICAL SURVEY DATA.
  - MANUAL REAR STEERING ONLY DEEMED NECESSARY IF NOTED WITHIN THE HIGHWAY WORKS PLAN.
  - ALL HIGHWAY WORKS HAVE BEEN CREATED ASSUMING AN ADDITIONAL 500mm EXTRA OVER THE AREA OF VEHICLE SWEEP PATH.
  - ENVIRONMENTAL ASSESSMENT OF PROPOSED WORKS TO BE UNDERTAKEN BY OTHERS.

REV	AMENDMENTS	BY	CHKD	APPRD	DATE
G	WELSH GOVERNMENT (TRANSPORT DIVISION) COMMENTS	JC	SDC	KM	10/12/13
F	WELSH GOVERNMENT (TRANSPORT DIVISION) COMMENTS	LA	SDC	KM	10/12/13
E	WELSH GOVERNMENT (TRANSPORT DIVISION) COMMENTS	JC	SDC	KM	17/12/13
D	WELSH GOVERNMENT (TRANSPORT DIVISION) COMMENTS	LA	SDC	KM	13/12/13
C	WELSH GOVERNMENT (TRANSPORT DIVISION) COMMENTS	LA	SDC	KM	12/12/13
B	CLIENT REVIEW	JC	SDC	KM	06/12/13
A	WORKSHOP COMMENTS	CD	SDC	KM	15/11/13
*	FIRST ISSUE	CD	EM	BC	06/11/13



CLIENT  
**RENEWABLEUK CYMRU**

PROJECT  
**STRATEGIC TRAFFIC MANAGEMENT PLAN FOR MID WALES WIND FARMS**

TITLE  
**FIGURE 6-4i  
SWEEP PATH ANALYSIS  
A483 EAST OF GLASCOED HALL**

STATUS  
**FOR INFORMATION**

DRAWN	CHECKED	APPROVED
RT	DM	KM
DATE 05/11/2013	DATE 08/11/2013	DATE 08/11/2013
DRAWING SCALE AS SHOWN	ORIGINAL DRAWING SIZE 594 x 841 - A1	

DRAWING NO: **108526-FIG-6-4i** REV: **G**



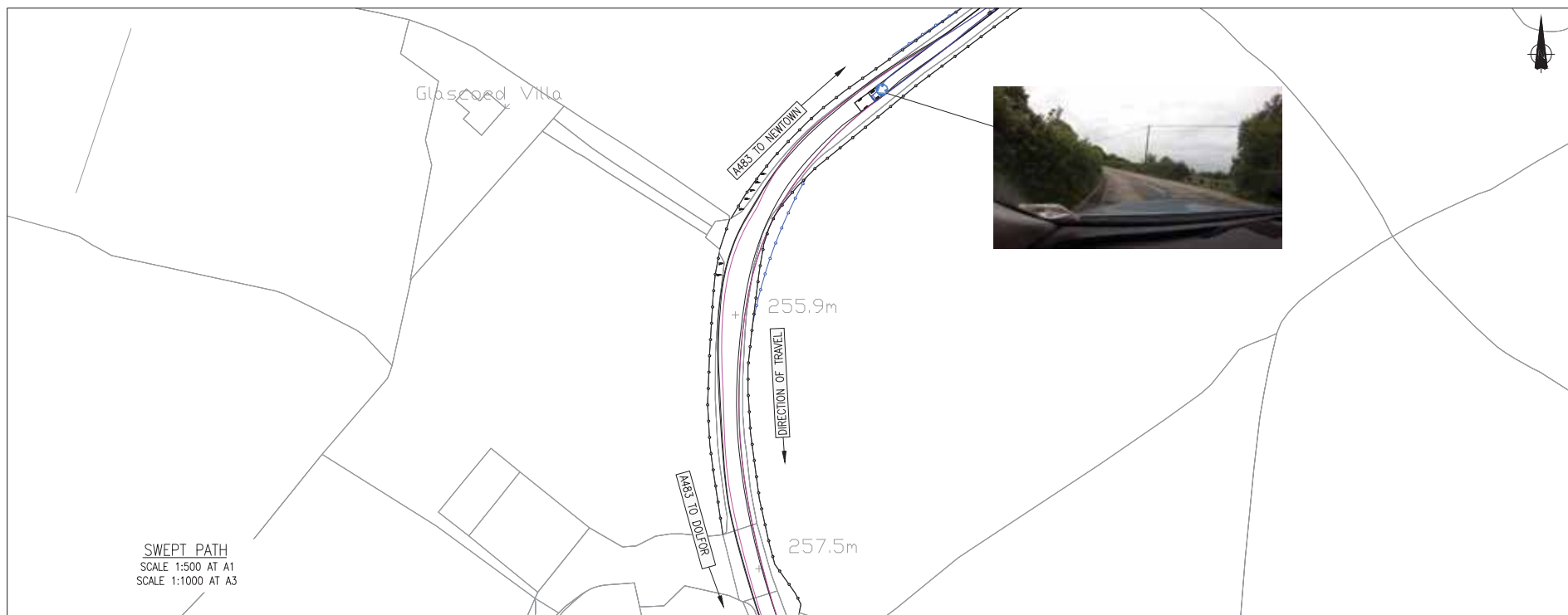

**NOTES**

**KEY-**

- ASSUMED LIMIT OF HIGHWAY LAND
- THIRD PARTY LAND
- EXISTING STREET FURNITURE
- RELOCATED STREET FURNITURE
- PHOTOGRAPH LOCATION AND DIRECTION
- LOAD OVERSAIL ENVELOPE
- CARRIAGEWAY IMPROVEMENT WORKS
- VEHICLE OVER-RUN CONSTRUCTION
- FOOTWAY WORKS
- RELOCATED HEDGELINE
- EARTHWORKS

- NOTES-**
1. AUTOTRACK SWEEP PATH ANALYSIS CARRIED OUT ASSUMING ABNORMAL LOAD ESCORTS ARE PRESENT.
  2. VEHICLE USED FOR SWEEP PATH ANALYSIS BASED UPON A 45m BLADE DELIVERY VEHICLE. REFER TO FIGURE 1-4g FOR FURTHER INFORMATION.
  3. SWEEP PATH ANALYSIS CARRIED OUT AGAINST ORDNANCE SURVEY AND LOCALISED TOPOGRAPHICAL SURVEY DATA.
  4. MANUAL REAR STEERING ONLY DEEMED NECESSARY IF NOTED WITHIN THE HIGHWAY WORKS PLAN.
  5. ALL HIGHWAY WORKS HAVE BEEN CREATED ASSUMING AN ADDITIONAL 500mm EXTRA OVER THE AREA OF VEHICLE SWEEP PATH.
  6. ENVIRONMENTAL ASSESSMENT OF PROPOSED WORKS TO BE UNDERTAKEN BY OTHERS.

REV	AMENDMENTS	BY	CHKD	APPRD	DATE
G	WELSH GOVERNMENT (TRANSPORT) DIVISION COMMENTS	JC	SDC	MM	10/12/13
F	WELSH GOVERNMENT (TRANSPORT) DIVISION COMMENTS	LA	SDC	MM	18/12/13
E	WELSH GOVERNMENT (TRANSPORT) DIVISION COMMENTS	JC	SDC	MM	17/12/13
D	WELSH GOVERNMENT (TRANSPORT) DIVISION COMMENTS	LA	SDC	MM	13/12/13
C	WELSH GOVERNMENT (TRANSPORT) DIVISION COMMENTS	LA	SDC	MM	12/12/13
B	CLIENT REVIEW	JC	SDC	MM	06/12/13
A	WORKSHOP COMMENTS	CD	SDC	MM	05/11/13
*	FIRST ISSUE	CD	EM	SC	08/11/13



CLIENT  
**RENEWABLEUK CYMRU**

PROJECT  
**STRATEGIC TRAFFIC MANAGEMENT PLAN FOR MID WALES WIND FARMS**

TITLE  
**FIGURE 6-4j  
SWEEP PATH ANALYSIS  
A483 OPPOSITE GLASCOED VILLA**

STATUS  
**FOR INFORMATION**

DRAWN	CHECKED	APPROVED
RT	DM	KM
DATE	DATE	DATE
05/11/2013	08/11/2013	08/11/2013
DRAWING SCALE	ORIGINAL DRAWING SIZE	
AS SHOWN	594 x 841 - A1	

DRAWING NO: **108526-FIG-6-4j** REV: **G**

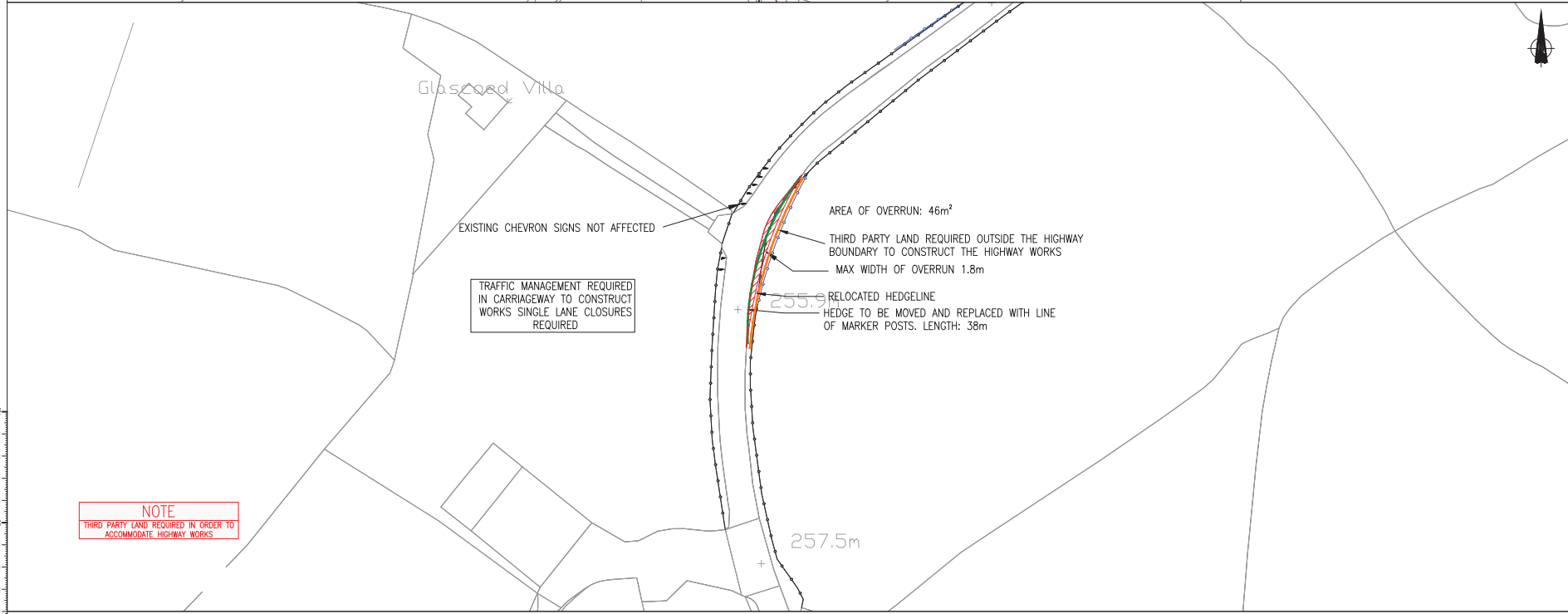

**NOTE**  
THIRD PARTY LAND REQUIRED IN ORDER TO ACCOMMODATE HIGHWAY WORKS

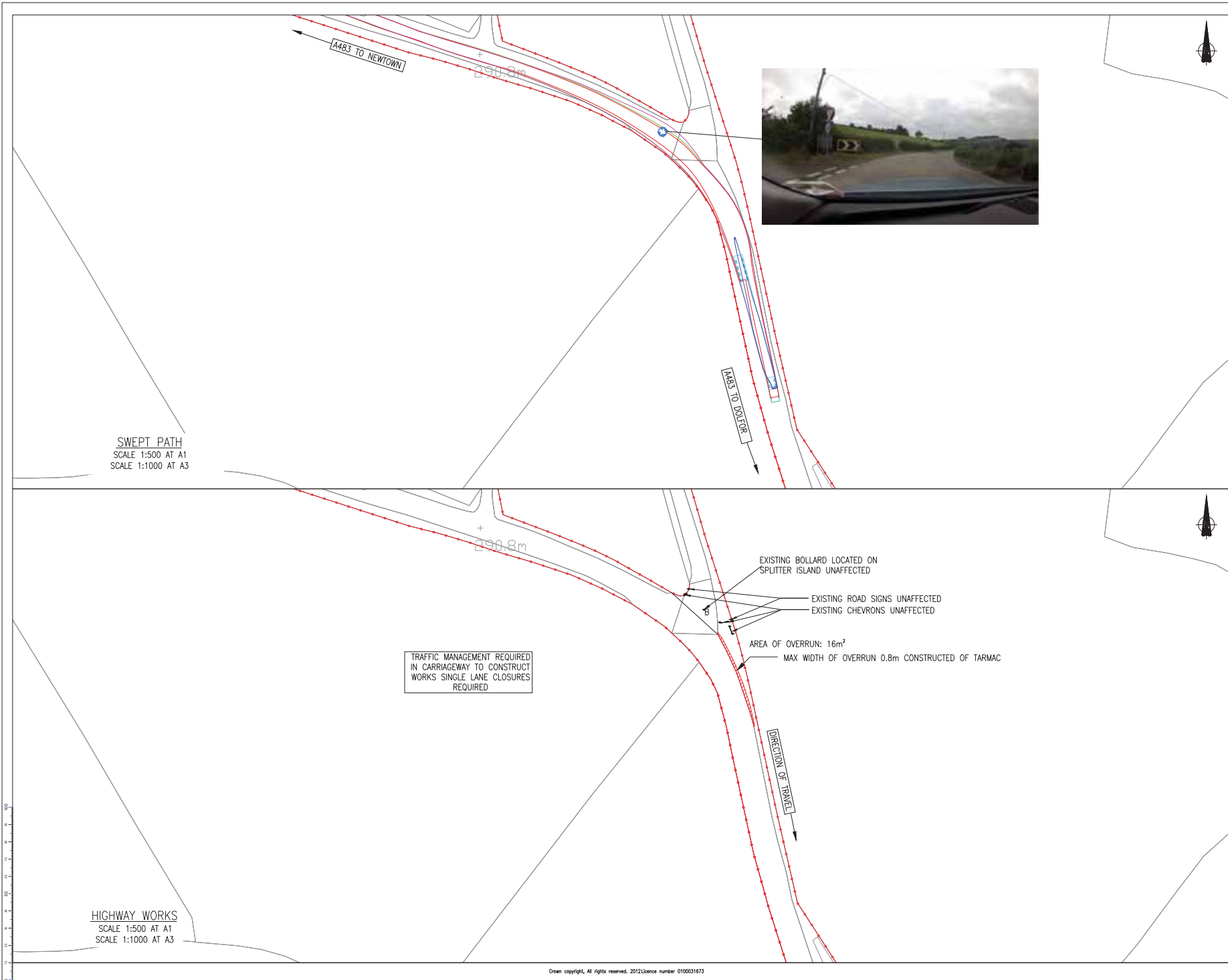

**NOTES**

KEY:-

- CHASSIS OVERSAIL
- VEHICLE OUTLINE
- CHASSIS SWEEP-PATH
- LOAD OVERSAIL
- ASSUMED LIMIT OF HIGHWAY LAND
- THIRD PARTY LAND
- EXISTING STREET FURNITURE
- RELOCATED STREET FURNITURE
- PHOTOGRAPH LOCATION AND DIRECTION
- LOAD OVERSAIL ENVELOPE
- CARRIAGEWAY IMPROVEMENT WORKS
- VEHICLE OVER-RUN CONSTRUCTION
- FOOTWAY WORKS
- EARTHWORKS

- NOTES:-**
1. AUTOTRACK SWEEP PATH ANALYSIS CARRIED OUT ASSUMING ABNORMAL LOAD ESCORTS ARE PRESENT.
  2. VEHICLE USED FOR SWEEP PATH ANALYSIS BASED UPON A 45m BLADE DELIVERY VEHICLE. REFER TO FIGURE 1-4g FOR FURTHER INFORMATION.
  3. SWEEP PATH ANALYSIS CARRIED OUT AGAINST ORDINANCE SURVEY AND LOCALISED TOPOGRAPHICAL SURVEY DATA.
  4. MANUAL REAR STEERING ONLY DEEMED NECESSARY IF NOTED WITHIN THE HIGHWAY WORKS PLAN.
  5. ALL HIGHWAY WORKS HAVE BEEN CREATED ASSUMING AN ADDITIONAL 500mm EXTRA OVER THE AREA OF VEHICLE SWEEP PATH.
  6. ENVIRONMENTAL ASSESSMENT OF PROPOSED WORKS TO BE UNDERTAKEN BY OTHERS.

F	WELSH GOVERNMENT (TRANSPORT DIVISION) COMMENTS	LA	SDC	KM	18/12/13
E	WELSH GOVERNMENT (TRANSPORT DIVISION) COMMENTS	JC	SDC	KM	17/12/13
D	WELSH GOVERNMENT (TRANSPORT DIVISION) COMMENTS	LA	SDC	KM	13/12/13
C	WELSH GOVERNMENT (TRANSPORT DIVISION) COMMENTS	LA	SDC	KM	13/12/13
B	CLIENT REVIEW	JC	SDC	KM	06/12/13
A	WORKSHOP COMMENTS	CD	SDC	KM	15/11/13
-	<b>FIRST ISSUE</b>	CD	DM	SC	08/11/13
REV	AMENDMENTS	BY	CHKD	APVD	DATE



CLIENT  
**RENEWABLEUK CYMRU**

PROJECT  
**STRATEGIC TRAFFIC MANAGEMENT PLAN FOR MID WALES WIND FARMS**

TITLE  
**FIGURE 6-4k  
SWEPT PATH ANALYSIS  
A483 NORTH OF DOLFOR**

STATUS  
**FOR INFORMATION**

DRAWN RT	CHECKED DM	APPROVED KM
DATE 05/11/2013	DATE 08/11/2013	DATE 08/11/2013
DRAWING SCALE AS SHOWN	ORIGINAL DRAWING SIZE 594 x 841 - A1	
DRAWING NO. 108526-FIG-6-4k	REV. F	



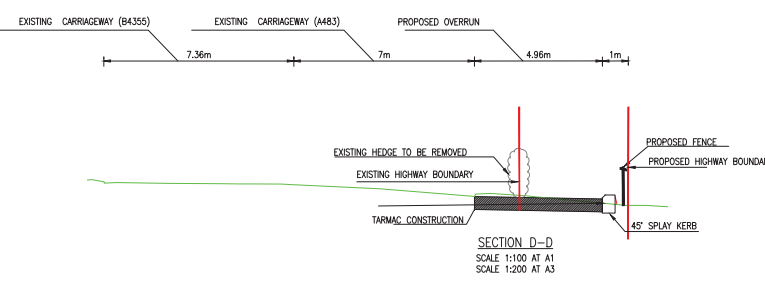
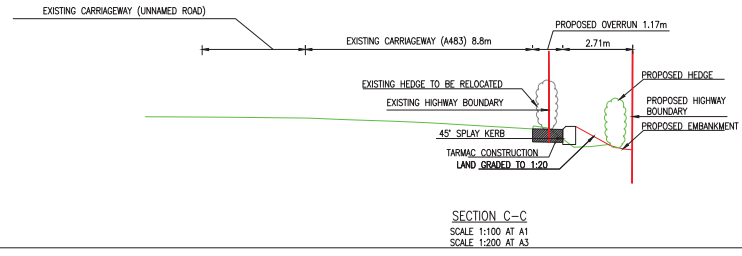
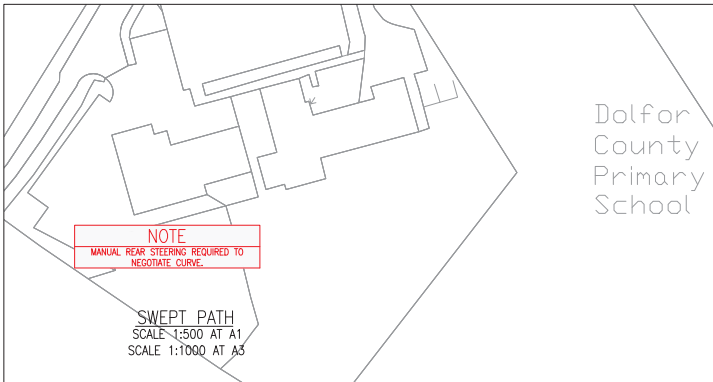

**NOTE**  
THIRD PARTY LAND REQUIRED IN ORDER TO ACCOMMODATE HIGHWAY WORKS

**HIGHWAY WORKS**  
SCALE 1:500 AT A1  
SCALE 1:1000 AT A3

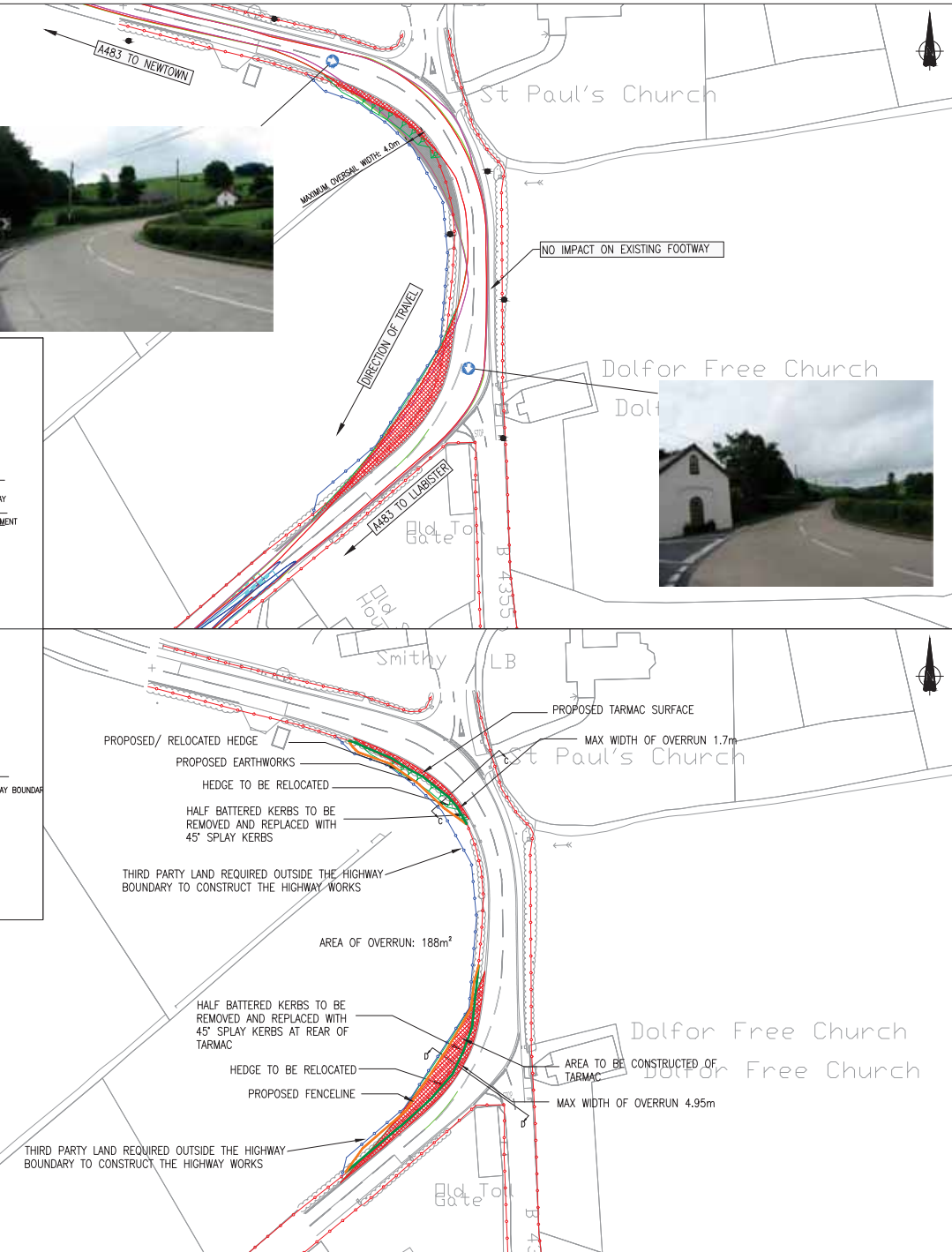

**NOTES**

**KEY:-**

- CHASSIS OVERSAIL
- VEHICLE OUTLINE
- CHASSIS SWEEP-PATH
- LOAD OVERSAIL
- ASSUMED LIMIT OF HIGHWAY LAND
- THIRD PARTY LAND
- EXISTING STREET FURNITURE
- RELOCATED STREET FURNITURE
- PHOTOGRAPH LOCATION AND DIRECTION
- LOAD OVERSAIL ENVELOPE
- CARRIAGEWAY IMPROVEMENT WORKS
- TARMAC SURFACE
- VEHICLE OVER-RUN CONSTRUCTION
- FOOTWAY WORKS
- EARTHWORKS

- NOTES:-**
- AUTOTRACK SWEEP PATH ANALYSIS CARRIED OUT ASSUMING ABNORMAL LOAD ESCORTS ARE PRESENT.
  - VEHICLE USED FOR SWEEP PATH ANALYSIS BASED UPON A 45m BLADE DELIVERY VEHICLE. REFER TO FIGURE 1-4a FOR FURTHER INFORMATION.
  - SWEEP PATH ANALYSIS CARRIED OUT AGAINST ORDNANCE SURVEY AND LOCALISED TOPOGRAPHICAL SURVEY DATA.
  - MANUAL REAR STEERING ONLY DEEMED NECESSARY IF NOTED WITHIN THE HIGHWAY WORKS PLAN.
  - ALL HIGHWAY WORKS HAVE BEEN CREATED ASSUMING AN ADDITIONAL 500mm EXTRA OVER THE AREA OF VEHICLE SWEEP PATH.
  - ENVIRONMENTAL ASSESSMENT OF PROPOSED WORKS TO BE UNDERTAKEN BY OTHERS.

F	WELSH GOVERNMENT (TRANSPORT DIVISION) COMMENTS	LA	SDC	KM	18/12/13
E	WELSH GOVERNMENT (TRANSPORT DIVISION) COMMENTS	JC	SDC	KM	17/12/13
D	WELSH GOVERNMENT (TRANSPORT DIVISION) COMMENTS	LA	SDC	KM	13/12/13
C	WELSH GOVERNMENT (TRANSPORT DIVISION) COMMENTS	LA	SDC	KM	12/12/13
B	CLIENT REVIEW	JC	SDC	KM	06/12/13
A	WORKSHOP COMMENTS	CD	SDC	KM	15/11/13
-	<b>FIRST ISSUE</b>	CD	DM	SC	15/11/13
REV	AMENDMENTS	BY	CHKD	APRD	DATE



CLIENT  
**RENEWABLEUK CYMRU**

PROJECT  
**STRATEGIC TRAFFIC MANAGEMENT PLAN FOR MID WALES WIND FARMS**

TITLE  
**FIGURE 6-4I SWEEP PATH ANALYSIS A483 DOLFOR**

STATUS  
**FOR INFORMATION**

DRAWN RT	CHECKED DM	APPROVED KM
DATE 05/11/2013	DATE 08/11/2013	DATE 08/11/2013
DRAWING SCALE AS SHOWN	ORIGINAL DRAWING SIZE 594 x 841 - A1	
DRAWING NO 108526-FIG-6-4I	REV F	